



## Introducing Corcom SR Series 20A Power Inlet Connectors

The Corcom SR Series includes a full line of popular AC receptacles. These male and female power line connectors include snap-in and flange mounted models. Now available in 20 Amp versions with flange mount and snap-in configurations. These AC receptacles feature a standard IEC60320-1 inlet for power cords and quick-disconnect terminals for load side connection.



**KEY FEATURES**

- New 20A Version
- Snap-in and Flange Mounting Options
- Operating Voltage 120/250 VAC
- UL Recognized and CSA Certified for 20A at 125V
- VDE Approved for 16A at 250VAC

**ORDERING INFORMATION**

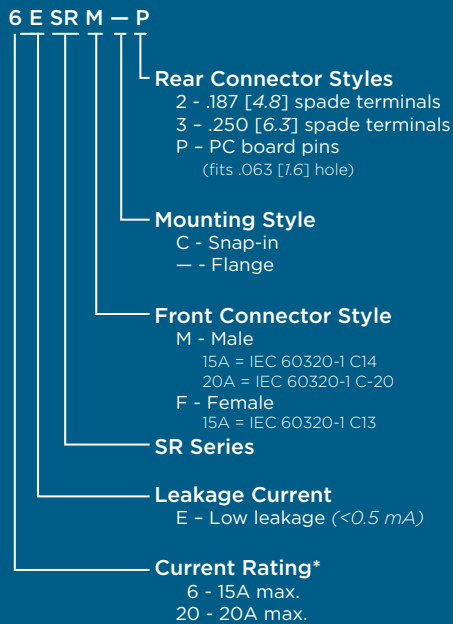

**STANDARDS AND SPECIFICATIONS**



- UL Recognized
- CSA Certified
- VDE Approved

**SPECIFICATIONS**

Rated Current	6ESR Models	20ESR Models
		15A Max.
Temperature Rating:	65°C for "cold" connections	
Insulator:	Thermoplastic UL 94V-0 flame rating	
Prongs:	Solid brass, nickel plated	
Terminals:	Brass, tin plated	

*\*15A versions are VDE approved at 10A, 250VAC.  
20A versions are VDE approved at 16A, 250VAC*

**PRODUCT OFFERING**

Type	Male Connector Part No.	Female Connector Part No.
PC Pins	6ESRM-P	-
15A (max.) Snap-In	6ESRMC2	6ESRFC3
15A (max.) Flange Mount	6ESRM-3	6ESRF-3
20A (max.) Snap-In	20ESRMC2	-
20A (max.) Flange Mount	20ESRM-3	-

**CASE DIMENSIONS**

Part No.	A	B	C	D	E
	(max)	+0.017 / -.006 +.43 / -.15	(max)	(max)	(max)
6ESRM-P	1.96	1.575	1.094	1.118	.807
	49.8	40.0	27.8	28.39	20.5
6ESRMC2	1.182	-	.885	-	1.192
	30.0	-	22.5	-	30.3
6ESRFC3	1.39	-	1.09	-	1.496
	35.5	-	27.8	-	38.0
6ESRM-3	1.96	1.575	.885	1.19	1.275
	49.8	40.0	22.5	30.23	32.4
6ESRF-3	1.953	1.575	1.133	-	1.496
	49.6	40.0	28.8	-	38.0
20ESRMC2	1.377	.921	1.06	-	-
	35.0	23.4	27.0	-	-
20ESRM-3	2.087	1.653	.999	-	1.318
	53.0	42.0	25.4	-	33.5

CASE STYLES

20A Inlets

20ESRMC2

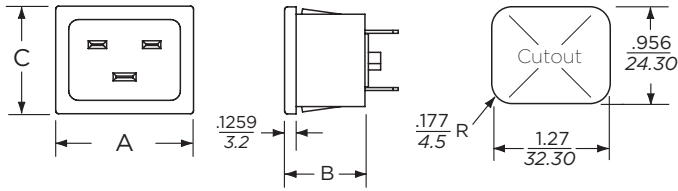

20ESRM-3

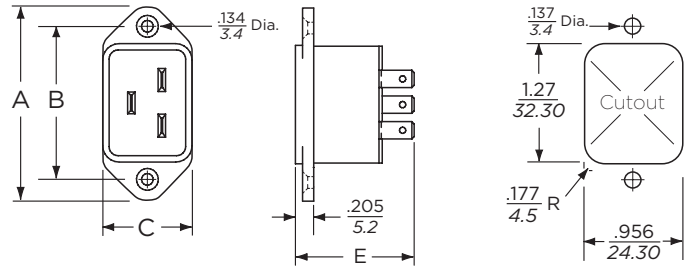

15A Inlets

6ESRM-P

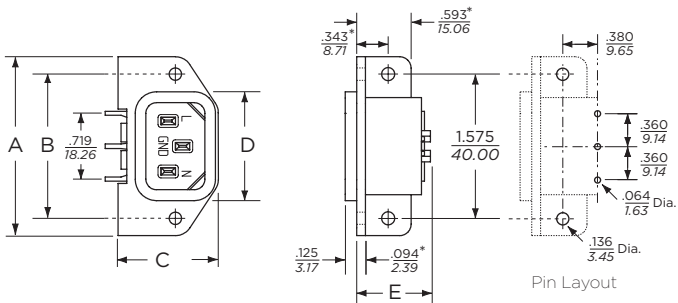

6ESRFC3

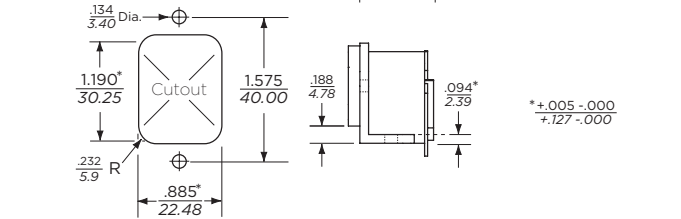
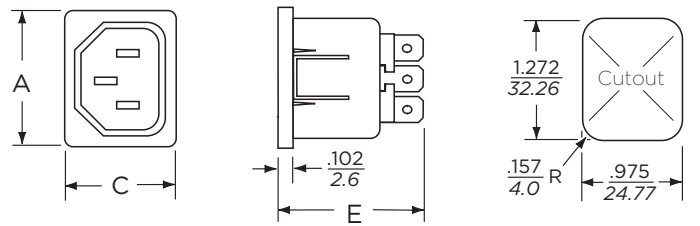

6ESRM-3

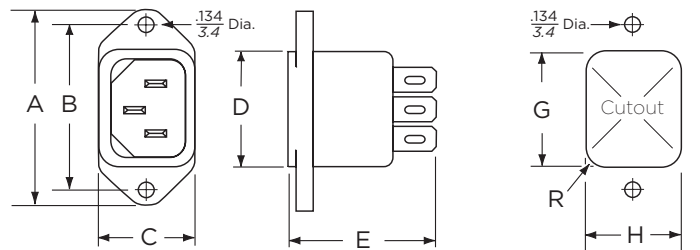

6ESRMC2

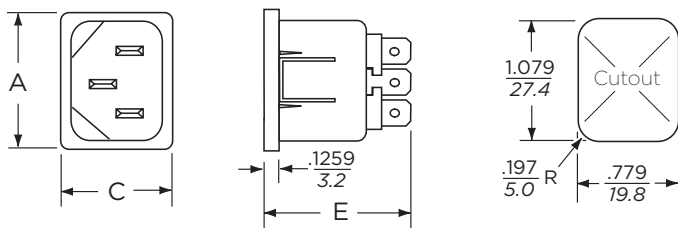

6ESRMC2

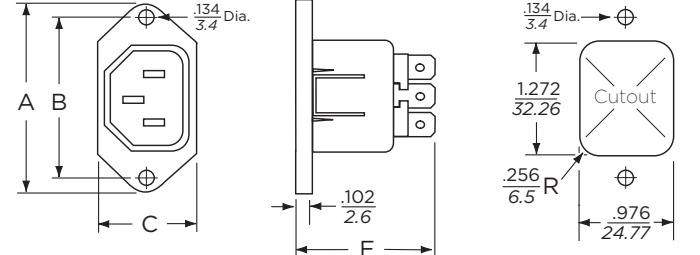

## FOR MORE INFORMATION

corcom.com

### TE Technical Support Center

Internet:	te.com/help
USA:	+1 (800) 522-6752
Canada:	+1 (905) 475-6222
Mexico:	+52 (0) 55-1106-0800
Latin/S. America:	+54 (0) 11-4733-2200
Germany:	+49 (0) 6251-133-1999
UK:	+44 (0) 800-267666
France:	+33 (0) 1-3420-8686
Netherlands:	+31 (0) 73-6246-999
China:	+86 (0) 400-820-6015

Part numbers in this brochure are RoHS Compliant\*, unless marked otherwise.

\*as defined [www.te.com/leadfree](http://www.te.com/leadfree)

### te.com

© 2011 Tyco Electronics Corporation, a TE Connectivity Ltd. company. All Rights Reserved.

8-1773460-7 CIS JG 05/2011

Corcom, TE Connectivity, TE connectivity (logo) and TE (logo) are trademarks. Other logos, product and/or company names might be trademarks of their respective owners.

---

While TE has made every reasonable effort to ensure the accuracy of the information in this brochure, TE does not guarantee that it is error-free, nor does TE make any other representation, warranty or guarantee that the information is accurate, correct, reliable or current. TE reserves the right to make any adjustments to the information contained herein at any time without notice. TE expressly disclaims all implied warranties regarding the information contained herein, including, but not limited to, any implied warranties of merchantability or fitness for a particular purpose. The dimensions in this catalog are for reference purposes only and are subject to change without notice. Specifications are subject to change without notice. Consult TE for the latest dimensions and design specifications.

