

## Silicon Bridge Rectifiers 50 Amps

The plastic material carries U/L recognition 94 V-O

TYPE	MAXIMUM AVERAGE RECT. CURRENT If (AV) @ T <sub>A</sub> R		INPUT VOLTAGE RECOMD. V <sub>rms</sub>	PEAK INVERSE VOLTAGE V <sub>rrm</sub>	MAXIMUM FWD PEAK SURGE CURRENT I <sub>fsm</sub>	MAXIMUM FWD VOLTAGE @ T <sub>A</sub> = 25° C V <sub>f</sub> @ I <sub>f</sub> (AV)		MAXIMUM REVERSE CURRENT @ T <sub>A</sub> = 25° C I <sub>r</sub>
	(A)	(C)	(V)	(V)	(A)	(V)	(A)	(uA)

BR5000 SERIES 50 Amps Figure 1

BR5000	50	55	20	50	400	1.1	25	10
BR5001	50	55	40	100	400	1.1	25	10
BR5002	50	55	80	200	400	1.1	25	10
BR5004	50	55	125	400	400	1.1	25	10
BR5006	50	55	250	600	400	1.1	25	10
BR5008	50	55	380	800	400	1.1	25	10
BR5010	50	55	440	1000	400	1.1	25	10

(PLASTIC CASE WITH METAL HEAK SINK)

DIM	INCHES		MILLIMETERS	
	MIN.	MAX.	MIN.	MAX.
A	0.688	0.728	17.5	18.5
B	1.12	1.13	28.4	28.7
C	0.53	0.57	13.5	14.5
D	0.618	0.658	15.7	16.7
E	0.20	0.21	5.1	5.3
F	0.618	0.658	15.7	16.7
G	0.028	0.032	0.71	0.84
H	0.248	0.252	6.3	6.40
I	0.826	0.905	21.0	23.0
J	0.09	0.10	2.4	2.6
K	0.28	0.31	7.30	7.90
L	0.28	0.31	7.30	7.90
M	0.004	0.008	0.1	0.2

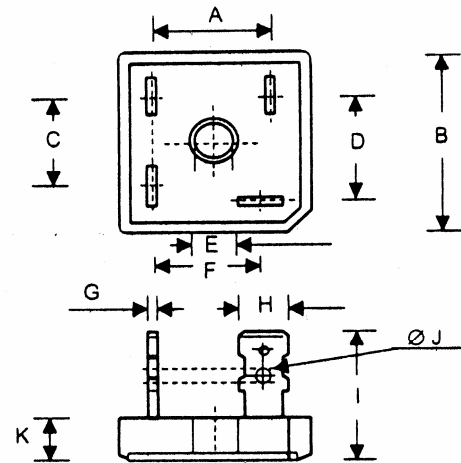

(203) 467-2591 TEL  
 (203) 469-5928 FAX  
 Email: Info@edal.com  
 Internet: <http://www.edal.com>

**EDAL industries, inc.**

51 Commerce St. East Haven, CT 06512