

D TYPE CONNECTORS - TURNED PIN

WIRE WRAP

- 9, 15, 25, 37 or 50 way
- Turned Pin (Machined) Contact
- Gold Plated Contacts
- Yellow Zinc Metal or Tin Housings available
- Current Rating - 5Amps



SPECIFICATION

Mechanical:

- Termination:** Hand Solder
Dip Solder straight
Dip Solder 90°C
Wire Wrap 0.6 x 0.6mm
- Polarisation:** by trapezoidal shell
- Coupling:** by friction, locking by special accessories
- Withdrawal force:** ca. 0.5 N per contact
- Material and Finishes:** Shell steel with yellow passivation over zinc plate (standard), steel nickel plated and tinned
- Insulators:** Two part mouldings, polyester, glass fibre re-enforced, flame retarded according UL 94 V0
- Contacts:** Gold plated over nickel
- Insertion Cycles:** 500

Electrical:

- Creeping Current Stability:** KB 220 according to DIN 53480
- Working Current:** 5A per contact with 20AWG cable
- Working Voltages:** 300V rms
- Test Voltage:** 1000V rms
- Contact Resistance:** below $5 \times 10^{-3} \Omega$
- Insulation Resistance:** over 10M Ω
- Temperature Range:** - 55°C to 125°C

SECTION 11

OUTLINE DRAWING

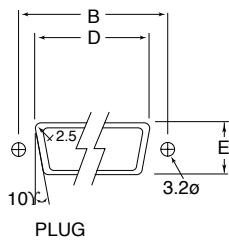
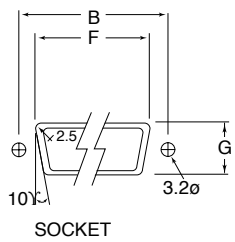

	A	B	C	D	E	F	G
9 WAY	30.8	25.0	12.4	22.2	13.0	20.5	11.4
15 WAY	39.2	33.3	12.4	30.5	13.0	28.8	11.4
25 WAY	53.1	47.0	12.4	44.3	13.0	42.5	11.4
37 WAY	69.5	63.5	12.4	60.7	13.0	59.1	11.4
50 WAY	67	61.1	15.4	58.3	13.0	56.3	14.1

Dimension - mm

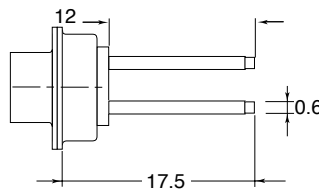
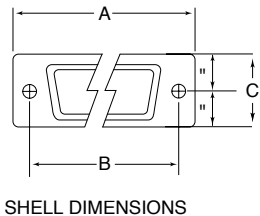

ORDERING INFORMATION

DBC	TD	M1	WW	09	3
Dubilier Connectors	Series	Connector Type	Contact Style	N° of Ways	
	TD = Turn Pin D	M1 = Male(plug) zinc F1 = Female(socket) zinc M2 = Male (plug) Tin F2 = Female (socket) Tin	WW = Wire Wrap	09 = 9ways 15 = 15ways 25 = 25ways 37 = 37ways 50 = 50ways	