



S8AP THRU S8MP

Surface Mount Standard Rectifiers

Features

- ◆ Low profile package
- ◆ Ideal for automated placement
- ◆ Glass passivated chip junction
- ◆ High forward surge capability

Mechanical Data

Case: SMP Molded plastic body

Terminals: Plated leads solderable per MIL-STD-750,
Method 2026

High temperature soldering guaranteed: 260°C/10 seconds

Polarity: Cathode line denotes the cathode end

Mounting Position: Any



SMP

Maximum Ratings & Electrical Characteristics

Ratings at TA = 25°C unless otherwise specified

Characteristic	Symbol	S8AP	S8BP	S8DP	S8GP	S8JP	S8KP	S8MP	Units
Peak repetitive reverse voltage	VRRM	50	100	200	400	600	800	1000	V
RMS reverse voltage	VRMS	35	70	140	280	420	560	700	V
DC blocking voltage	VDC	50	100	200	400	600	800	1000	V
Maximum average forward output current	IF(AV)	8							A
Peak forward surge current, 8.3ms single half-sine-wave, @TJ = 25°C	IFSM	200							A
Rating for fusing (t<8.3ms)	I2t	166.0							A2sec
Maximum instantaneous forward voltage @ 8A	VF	1.1							V
Maximum Reverse current Rated VR	IR	@TA =25°C							μ A
		@TA =125°C							
Operating junction temperature range	TJ	- 55 ---- + 150							°C
Storage temperature range	TSTG	- 55 ---- + 150							°C



S8AP THRU S8MP

Surface Mount Standard Rectifiers

Ratings and Characteristic Curves ($T_A=25^\circ\text{C}$ unless otherwise noted)

Fig.1-Forward Current Derating Curve

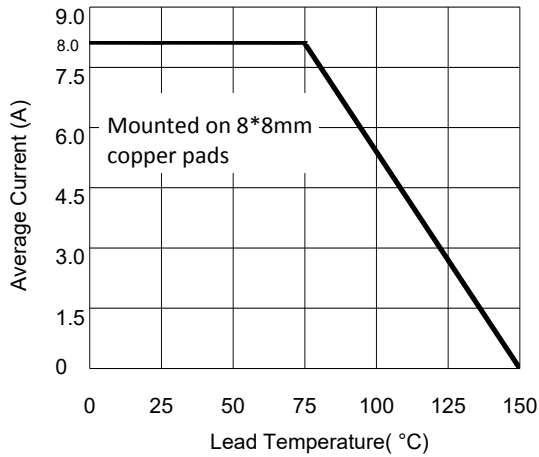

Fig.2- Surge Current Derating Curve

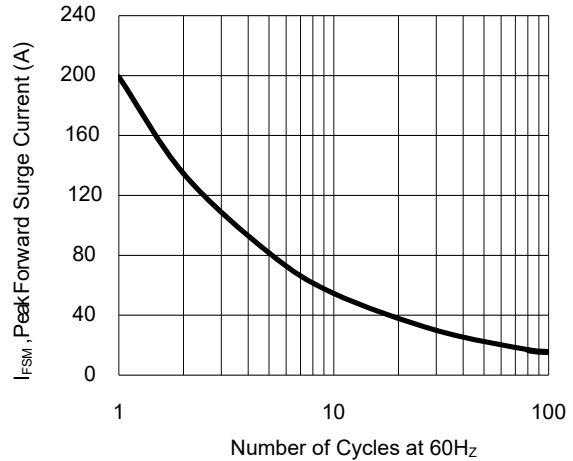

Fig.3- Typical Forward Voltage Characteristic

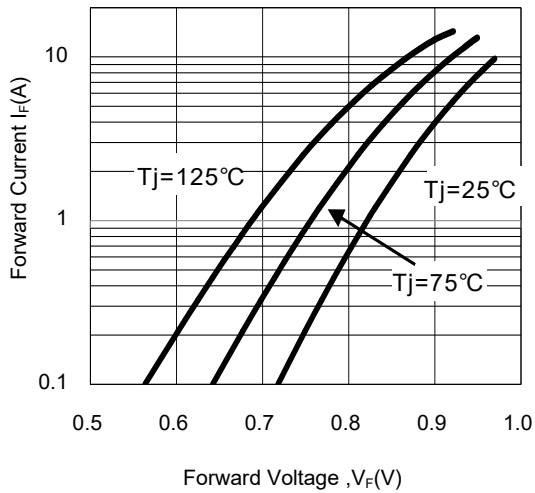
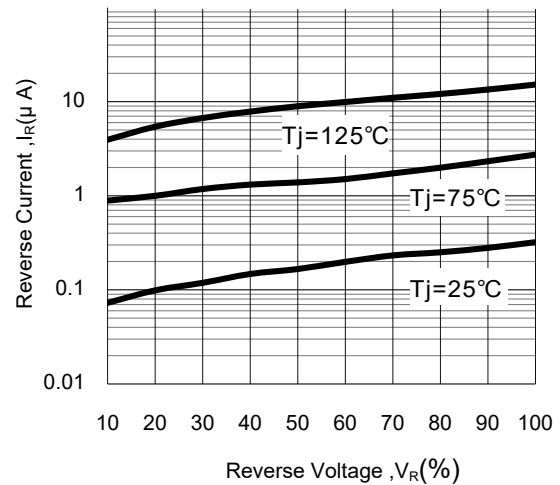

Fig.4- Typical Reverse Characteristic





S8AP THRU S8MP

Surface Mount Standard Rectifiers

Package Outline Dimensions(unit:mm)

SMP

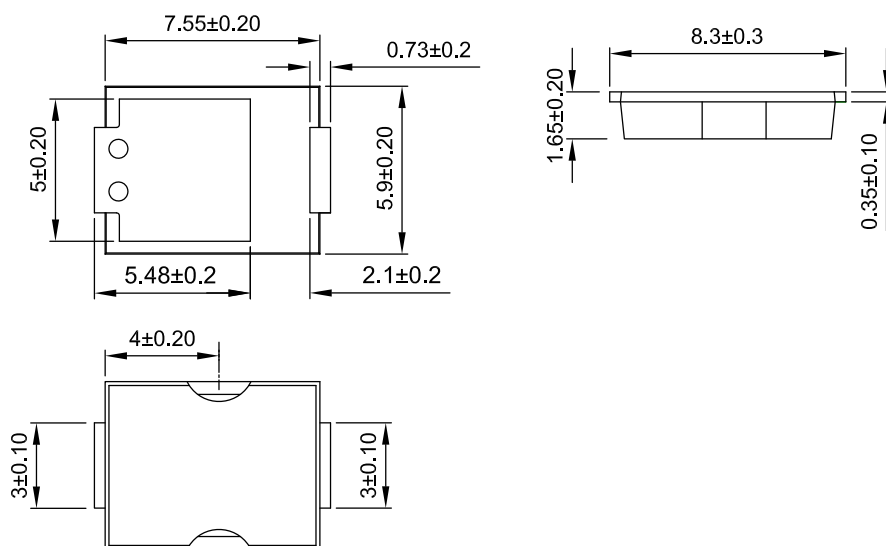

Mounting Pad Layout(unit:mm)

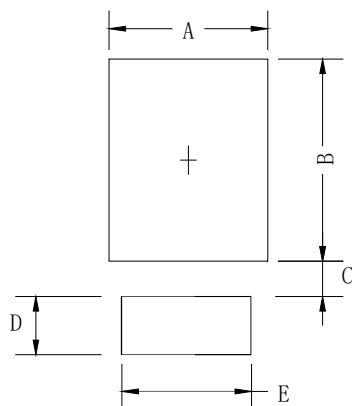

Dim	Millimeters
A	5.40
B	6.40
C	1.25
D	1.70
E	4.00

Ordering Information

Part No.	Marking	Package	Shipping
S8AP	S8AP	SMP	3000PCS /Tape&Reel
S8BP	S8BP	SMP	3000PCS /Tape&Reel
S8DP	S8DP	SMP	3000PCS /Tape&Reel
S8GP	S8GP	SMP	3000PCS /Tape&Reel
S8JP	S8JP	SMP	3000PCS /Tape&Reel
S8KP	S8KP	SMP	3000PCS /Tape&Reel
S8MP	S8MP	SMP	3000PCS /Tape&Reel

