

1SS355

SILICON EPITAXIAL HIGH SPEED SWITCHING DIODE

Features

- Small plastic package suitable for surface mounted design
- High Speed ($T_{rr} = 1.2 \text{ ns Typ.}$)
- High reliability with high surge current handling capability
- RoHS compliant package

Applications

- High speed switching

Description

- Silicon planar zener diode in a small plastic SMD SOD-323 package

Packing & Order Information

3,000/Reel



**RoHS
COMPLIANT**

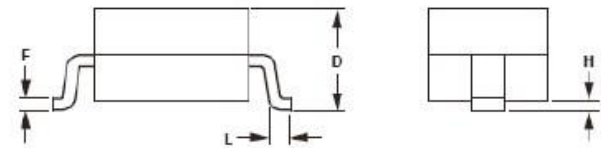
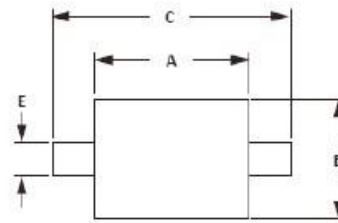

OUTLINE DIMENSIONS				
DIM	MILLIMETERS		INCHES	
	MIN	MAX	MIN	MAX
A	1.60	1.90	0.063	0.075
B	1.15	1.45	0.045	0.057
C	2.39	2.70	0.094	0.106
D	0.80	1.10	0.031	0.043
E	0.25	0.40	0.010	0.016
F	0.10	0.20	0.004	0.008
H	-	0.10	-	0.004
L	0.20	-	0.008	-

NOTES
 1. Controlling dimension: millimeters.
 2. Dimensioning and tolerances per ANSI Y14.5M, 1985.
 3. Dimensions are exclusive of mold flash and metal burrs.

Graphic symbol



MAXIMUM RATINGS AND ELECTRICAL CHARACTERISTICS

Maximum Ratings and Thermal Characteristics (Rating at 25 °C ambient temperature unless otherwise specified.)

Parameter	Symbol	Value	Unit
Maximum Peak Reverse Voltage	VRRM	90	V
Maximum DC Reverse Voltage	VRM	80	V
Maximum Average Forward Current	IF	100	mA
Maximum Peak Forward Voltage	IFM	255	mA
Maximum Surge Current (1s)	IFSM	500	mA
Maximum Junction Temperature	TJ	125	°C
Storage temperature range	TS	-55 to +175	°C

1SS355

SILICON EPITAXIAL HIGH SPEED SWITCHING DIODE

Electrical characteristics (Tc=25°C unless otherwise noted)

Parameter	Test Condition	Symbol	Min.	Typ.	Max.	Unit
Forward Voltage	$I_F = 100 \text{ mA}$	VF	--	--	1.2	V
Reverse Current	$V_R = 80 \text{ V}$	IR	--	--	0.1	μA
Capacitance between terminals	$f = 1\text{MHz} ; V_R = 0.5$	CT	--	--	3.0	pF
Reverse Recovery Time	$I_F = 10 \text{ mA} , V_R = 6 \text{ V}$ $R_L = 100 \Omega$	Trr	--	--	4.0	ns

1SS355

SILICON EPITAXIAL HIGH SPEED SWITCHING DIODE

■ RATING AND CHARACTERISTIC CURVES (1SS355)

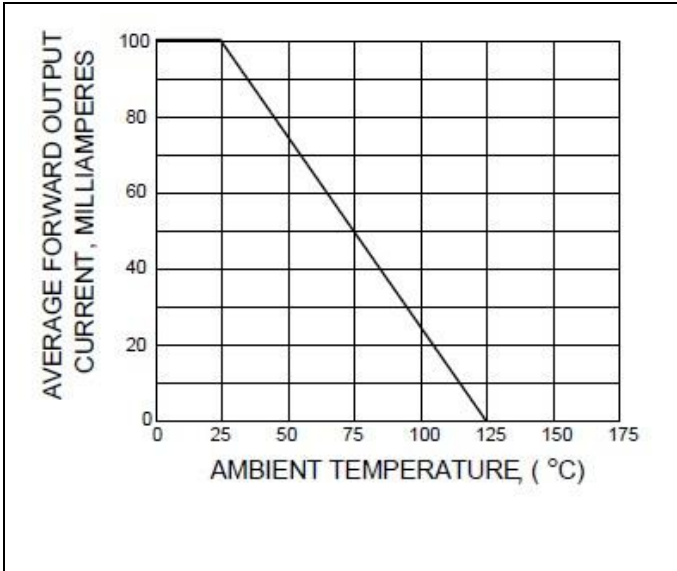

FIG.1- FORWARD CURRENT DERATING CURVE

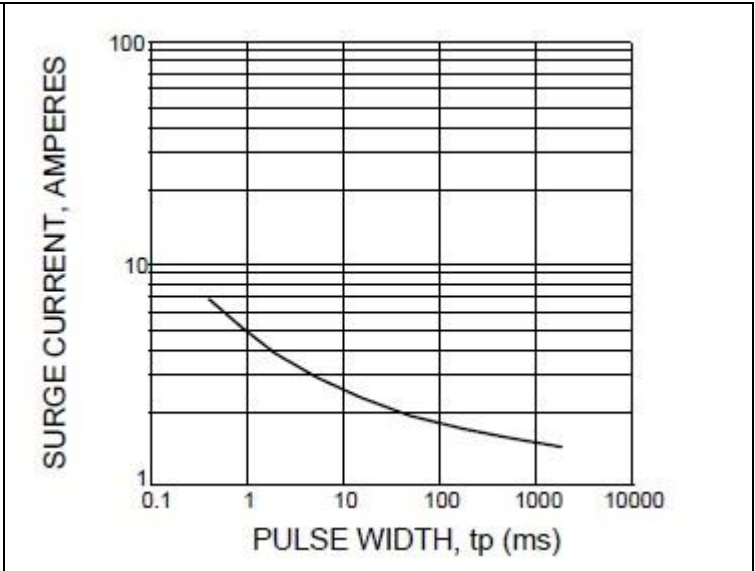

FIG.2- MAXIMUM SURGE CURRENT

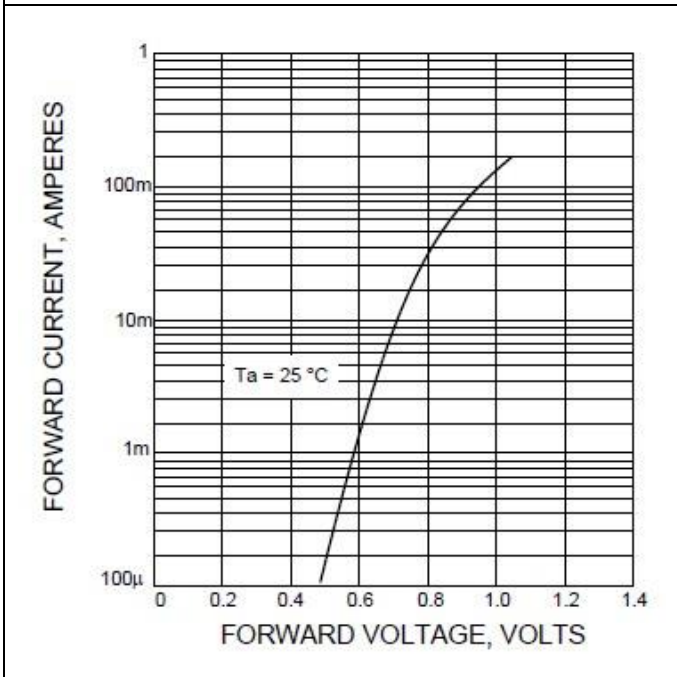

FIG.3- TYPICAL FORWARD CHARACTERISTICS

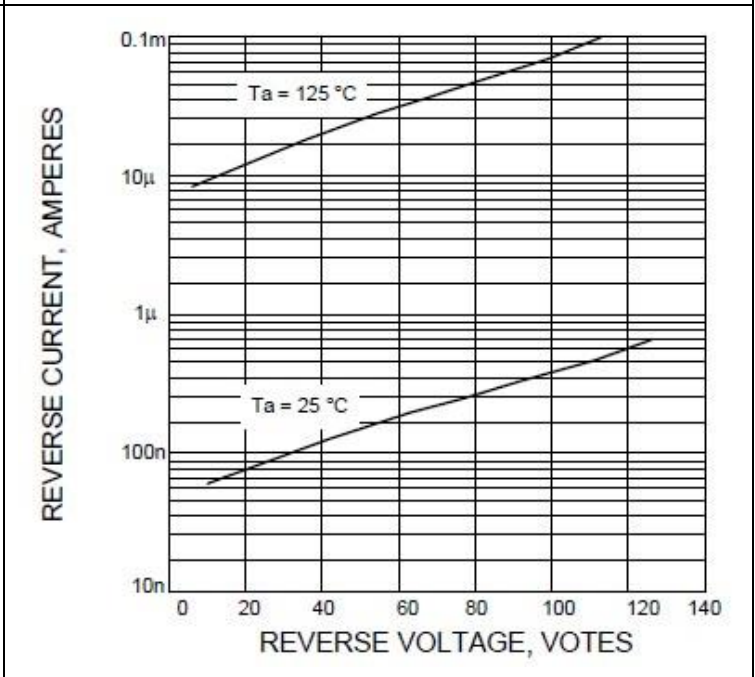

FIG.4- TYPICAL REVERSE CHARACTERISTICS

1SS355

SILICON EPITAXIAL HIGH SPEED SWITCHING DIODE

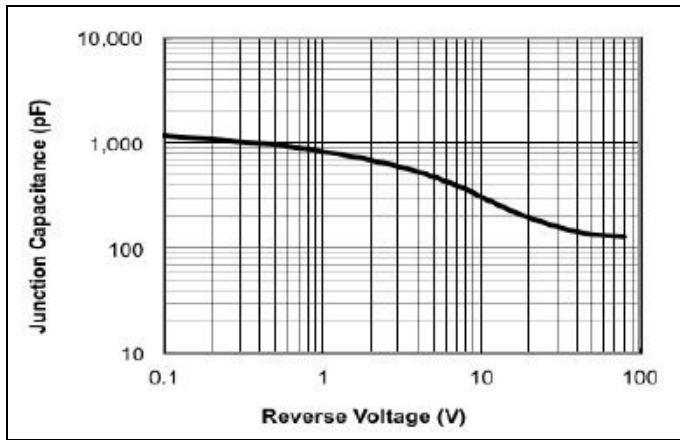

FIG.5- TYPICAL JUNCTION CAPACITANCE

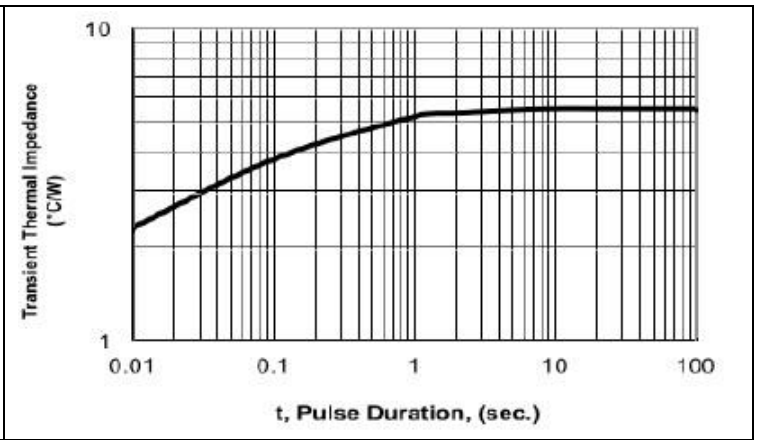

FIG.6- TYPICAL TARNSIENT THERMAL IMPEDANCE

1SS355

SILICON EPITAXIAL HIGH SPEED SWITCHING DIODE

Disclaimer

ALL PRODUCT, PRODUCT SPECIFICATIONS AND DATA ARE SUBJECT TO CHANGE WITHOUT NOTICE TO IMPROVE RELIABILITY, FUNCTION OR DESIGN OR OTHERWISE. Bruckewell Technology Inc., its affiliates, agents, and employees, and all persons acting on its or their behalf (collectively, "Bruckewell"), disclaim any and all liability for any errors, inaccuracies or incompleteness contained in any datasheet or in any other disclosure relating to any product. Bruckewell makes no warranty, representation or guarantee regarding the suitability of the products for any particular purpose or the continuing production of any product. To the maximum extent permitted by applicable law, Bruckewell disclaims

- (i) Any and all liability arising out of the application or use of any product.
- (ii) Any and all liability, including without limitation special, consequential or incidental damages.
- (iii) Any and all implied warranties, including warranties of fitness for particular purpose, non-infringement and merchantability.

Statements regarding the suitability of products for certain types of applications are based on Bruckewell's knowledge of typical requirements that are often placed on Bruckewell products in generic applications.

Such statements are not binding statements about the suitability of products for a particular application. It is the customer's responsibility to validate that a particular product with the properties described in the product specification is suitable for use in a particular application. Parameters provided in datasheets and/or specifications may vary in different applications and performance may vary over time.

Product specifications do not expand or otherwise modify Bruckewell's terms and conditions of purchase, including but not limited to the warranty expressed therein.