



NPN 2N2894

HIGH-SPEED SATURATED SWITCHES

The 2N2894 are silicon planar epitaxial PNP transistors mounted in TO-18 metal package. They are intended for high speed, low saturation switching applications up to 100 mA. Compliance to RoHS.

ABSOLUTE MAXIMUM RATINGS

Symbol	Ratings	Value	Unit
V_{CEO}	Collector-Emitter Voltage ($I_B = 0$)	-12	V
V_{CBO}	Collector-Base Voltage ($I_E = 0$)	-12	V
V_{CES}	Collector-Emitter Voltage ($V_{BE} = 0$)	-12	V
V_{EBO}	Emitter-Base Voltage ($I_C = 0$)	-4	V
I_C	Collector Current	-200	mA
P_D	Total Power Dissipation	@ $T_{amb} = 25^\circ$	0.36
		@ $T_{case} = 25^\circ$	1.2
		@ $T_{case} < 100^\circ$	1
T_J	Junction Temperature	-65 to +200	$^\circ\text{C}$
T_{Stg}	Storage Temperature range	-65 to +200	$^\circ\text{C}$

THERMAL CHARACTERISTICS

Symbol	Ratings	Value	Unit
R_{thJ-a}	Thermal Resistance, Junction-ambient	486	$^\circ\text{C}/\text{W}$
R_{thJ-c}	Thermal Resistance, Junction-case	146	$^\circ\text{C}/\text{W}$

NPN 2N2894

ELECTRICAL CHARACTERISTICS

TC=25°C unless otherwise noted

Symbol	Ratings	Test Condition(s)	Min	Typ	Max	Unit
I_{CBO}	Collector Cutoff Current	$V_{CB} = -6\text{ V}$, $I_E = 0\text{ V}$ $T_j = 125^\circ\text{C}$	-	-	-10	μA
I_{CES}	Collector Cutoff Current	$V_{BE} = 0\text{ V}$, $V_{CE} = -6\text{ V}$	-	-	-80	nA
$V_{CEO} (*)$	Collector Emitter Breakdown Voltage	$I_C = -10\text{ mA}$, $I_B = 0$	-12	-	-	V
V_{CES}	Collector Emitter Breakdown Voltage	$V_{BE} = 0\text{ V}$, $I_C = -10\ \mu\text{A}$	-12	-	-	V
V_{CBO}	Collector Base Breakdown Voltage	$I_C = -10\ \mu\text{A}$, $I_E = 0$	-12	-	-	V
V_{EBO}	Emitter Base Breakdown Voltage	$I_E = -100\ \mu\text{A}$, $I_C = 0$	-4	-	-	V
$h_{FE} (*)$	DC Current Gain	$I_C = -10\text{ mA}$, $V_{CE} = -0.3\text{ V}$	30	-	-	-
		$I_C = -30\text{ mA}$, $V_{CE} = -0.5\text{ V}$	40	-	150	
		$I_C = -100\text{ mA}$, $V_{CE} = -1\text{ V}$	25	-	-	
		$I_C = 150\text{ mA}$, $V_{CE} = 10\text{ V}$ $T_{amb} = -55^\circ$	17	-	-	
$V_{CE(SAT)} (*)$	Collector-Emitter saturation Voltage	$I_C = -10\text{ mA}$, $I_B = -1\text{ mA}$	-	-	-0.15	V
		$I_C = -30\text{ mA}$, $I_B = -3\text{ mA}$	-	-	-0.2	
		$I_C = -100\text{ mA}$, $I_B = -10\text{ mA}$	-	-	-0.5	
$V_{BE(SAT)} (*)$	Base-Emitter saturation Voltage	$I_C = -10\text{ mA}$, $I_B = -1\text{ mA}$	-0.78	-	-0.98	
		$I_C = -30\text{ mA}$, $I_B = -3\text{ mA}$	-0.85	-	-1.2	
		$I_C = -100\text{ mA}$, $I_B = -10\text{ mA}$	-	-	-1.7	
f_T	Transition frequency	$I_C = -30\text{ mA}$, $V_{CE} = -10\text{ V}$ $f = 100\text{ MHz}$	400	-	-	MHz
C_{CBO}	Collector-Base Capacitance	$I_E = 0$, $V_{CB} = -5\text{ V}$ $f = 1\text{ MHz}$	-	-	6	pF
C_{EBO}	Emitter-Base Capacitance	$I_C = 0$, $V_{EB} = -0.5\text{ V}$ $f = 1\text{ MHz}$	-	-	6	pF
t_{on}	Turn-on Time	$I_C = -30\text{ mA}$, $V_{CC} = -2\text{ V}$ $I_{B1} = -1.5\text{ mA}$	-	-	60	ns
t_{off}	Turn-off Time	$I_C = -30\text{ mA}$, $V_{CC} = -2\text{ V}$ $I_{B1} = -I_{B2} = -1.5\text{ mA}$	-	-	90	

(*) Pulse conditions : $t_p < 300\ \mu\text{s}$, $\delta = 1\%$

NPN 2N2894

MECHANICAL DATA CASE TO-18

DIMENSIONS (mm)		
	min	max
A	12.7	-
B	-	0.49
C	0.9	-
D	-	5.3
E	-	4.9
F	-	5.8
G	2.54	-
H	-	1.2
I	-	1.16
L	45°	-

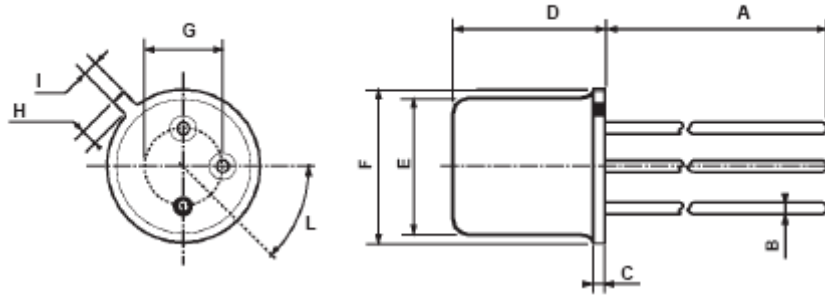

Pin 1 :	emitter
Pin 2 :	base
Pin 3 :	Collector
Case :	Collector

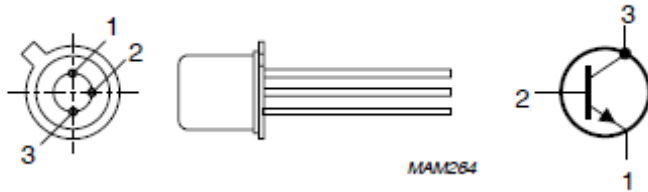

Revised August 2012

Information furnished is believed to be accurate and reliable. However, Comset Semiconductors assumes no responsibility for the consequences of use of such information nor for any infringement of patents or other rights of third parties which may result from its use. Data are subject to change without notice. Comset Semiconductors makes no warranty, representation or guarantee regarding the suitability of its products for any particular purpose, nor does Comset Semiconductors assume any liability arising out of the application or use of any product and specifically disclaims any and all liability, including without limitation consequential or incidental damages. Comset Semiconductors' products are not authorized for use as critical components in life support devices or systems.