

## PNP Epitaxial Planar Silicon Transistors

## 2SB1073

### FEATURES

- Low collector-emitter saturation voltage  $V_{CE(sat)}$ .
- Large peak collector current  $I_{CP}$ .
- Mini Power type package, allowing downsizing of the equipment and automatic insertion through the tape packing and the magazine packing.

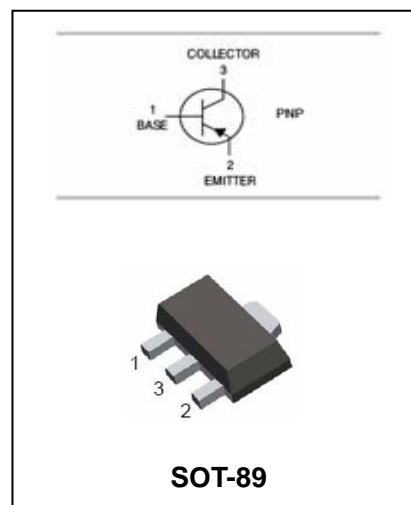

### ORDERING INFORMATION

Type No.	Marking	Package Code
2SB1073	IQ/IR	SOT-89

### MAXIMUM RATING @ $T_a=25^\circ\text{C}$ unless otherwise specified

Symbol	Parameter	Value	Unit
$V_{CBO}$	Collector-Base Voltage	-30	V
$V_{CEO}$	Collector-Emitter Voltage	-20	V
$V_{EBO}$	Emitter-Base Voltage	-7	V
$I_C$	Collector Current	-4	A
$I_{CP}$	Peak collector current	-7	A
$P_C$	Collector Dissipation	1	W
$T_j, T_{stg}$	Junction and Storage Temperature	-55 to +150	$^\circ\text{C}$



**PNP Epitaxial Planar Silicon Transistors**

**2SB1073**

**ELECTRICAL CHARACTERISTICS @ Ta=25°C unless otherwise specified**

Parameter	Symbol	Test conditions	MIN	TYP	MAX	UNIT
Collector-base breakdown voltage	$V_{(BR)CBO}$	$I_C = -10\mu A, I_E = 0$	-30			V
Collector-emitter breakdown voltage	$V_{(BR)CEO}$	$I_C = -1mA, I_B = 0$	-20			V
Emitter-base breakdown voltage	$V_{(BR)EBO}$	$I_E = -10\mu A, I_C = 0$	-7			V
Collector cut-off current	$I_{CBO}$	$V_{CB} = -30V, I_E = 0$			-0.1	$\mu A$
Emitter cut-off current	$I_{EBO}$	$V_{EB} = -7V, I_C = 0$			-0.1	$\mu A$
DC current gain	$h_F$	$V_{CE} = -2V, I_C = -2A$	120		315	
Collector-emitter saturation voltage	$V_{CE(sat)}$	$I_C = -3A, I_B = -0.1A$		-0.6	-1.0	V
Transition frequency	$f_T$	$V_{CB} = -6V, I_E = -50mA,$ $f = 200MHz$		120		MHz
Output Capacitance	$C_{obo}$	$V_{CB} = -20V, f = 1.0MHz, I_E = 0$		40		pF

**CLASSIFICATION OF  $h_{FE}$**

Rank	Q	R
Range	120-205	180-315
Marking	IQ	IR



PNP Epitaxial Planar Silicon Transistors

2SB1073

TYPICAL CHARACTERISTICS @  $T_a=25^\circ\text{C}$  unless otherwise specified

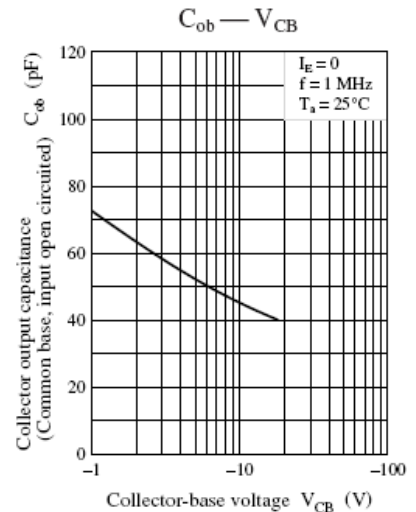
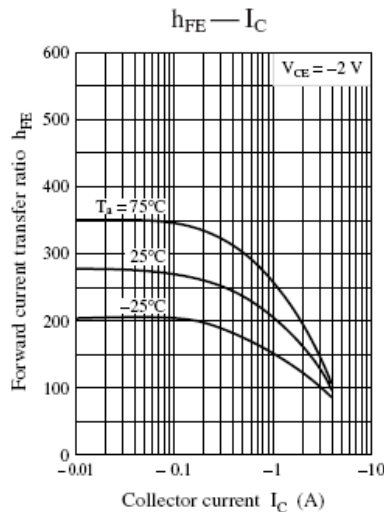
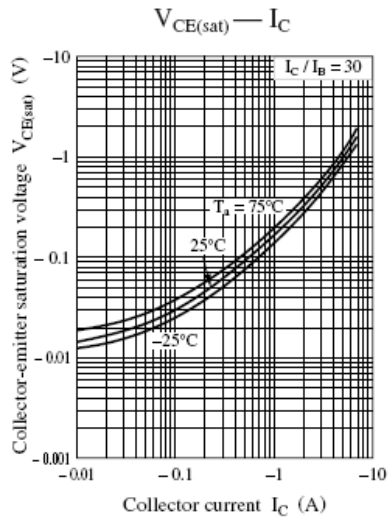
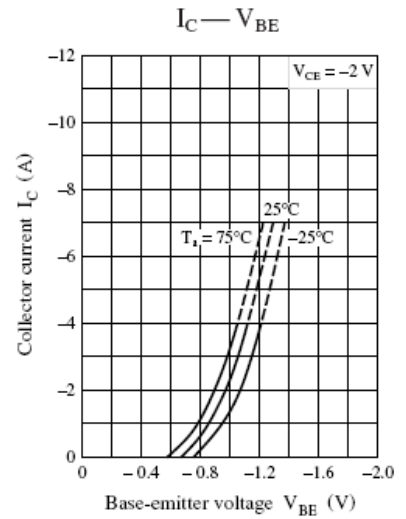
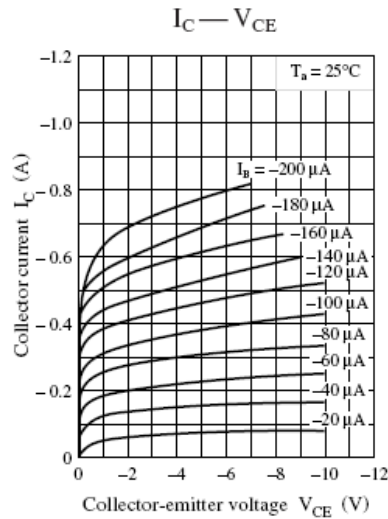
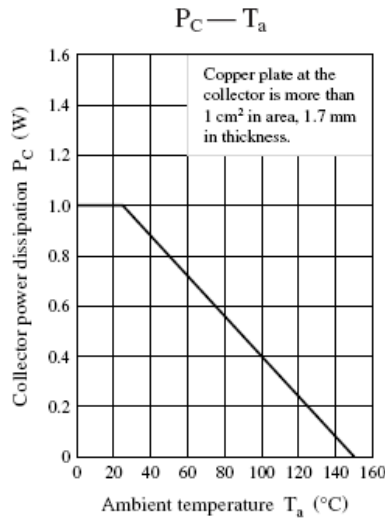



**PNP Epitaxial Planar Silicon Transistors**

**2SB1073**

**PACKAGE OUTLINE**

Plastic surface mounted package

SOT-89

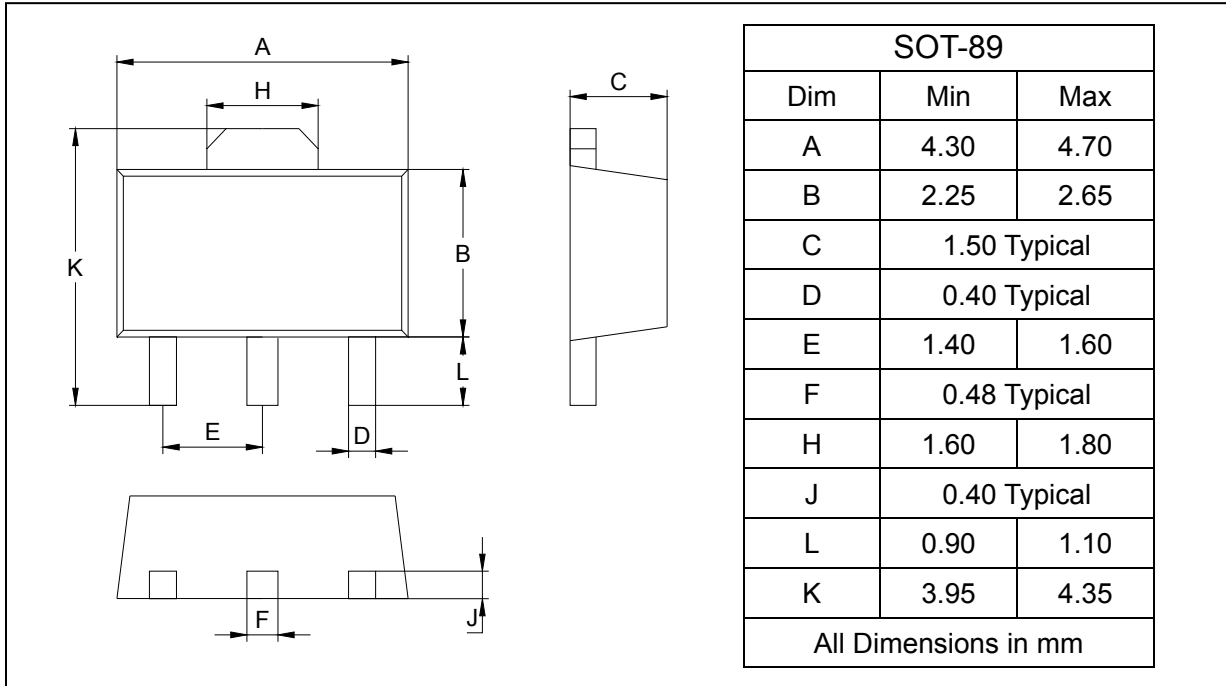

**SOLDERING FOOTPRINT**

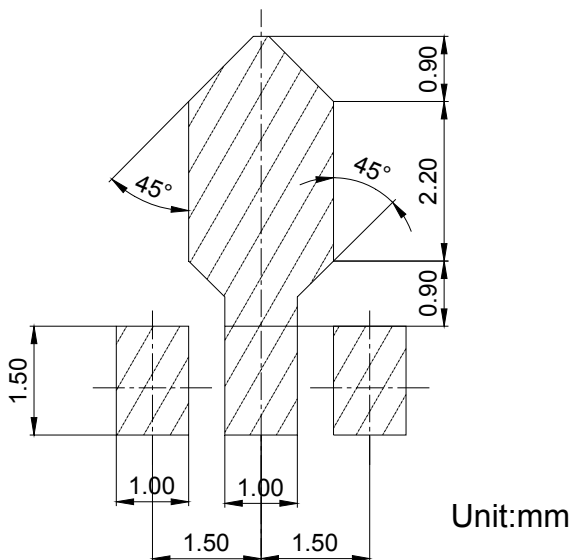

**PACKAGE INFORMATION**

Device	Package	Shipping
2SB1073	SOT-89	1000/Tape&Reel