

Adjustable RF Inductors

Special Features

- High inductance
- Wide tuning range
- Cup core construction for low radiation
- Static shielding can with grounding taps
- Min. SRF measured at max. inductance
- Operating temperature -55 to +105°C

9100 Series								
Part Number	L (uH)		Q		Test Freq. (MHz)	SRF (MHz)	DCR (Ω)	I (mA)
	Max.	Min.	Max.	Min.				
9101	0.099	64	0.134	85	25	400	0.01	4850
9102	0.129	70	0.192	93	25	333	0.01	4430
9103	0.165	77	0.258	100	25	288	0.02	3970
9104	0.246	83	0.418	102	25	225	0.02	3830
9105	0.366	88	0.627	93	25	185	0.02	3430
9106	0.588	40	0.95	60	25	155	0.9	516
9107	0.83	43	1.54	50	7.9	116	1.02	485
9108	1.44	34	2.94	64	7.9	84	1.38	417
9109	2.52	40	5.7	77	7.9	60	1.76	368
9110	5.35	50	13.49	60	2.5	37.4	2.92	286
9111	12.5	31	29.45	60	2.5	9.7	4.72	225
9112	26.25	35	71.25	54	2.5	5.1	6.97	185
9113	64.57	36	163	50	0.79	3.1	9.98	155
9114	147	31	430	52	0.79	2.1	16.32	121
9115	422	40	1100	42	0.25	1.4	27.84	92
9116	1050	39	3740	65	0.25	0.88	41.06	76
9117	3360	40	11,120	50	0.079	0.58	78.92	55

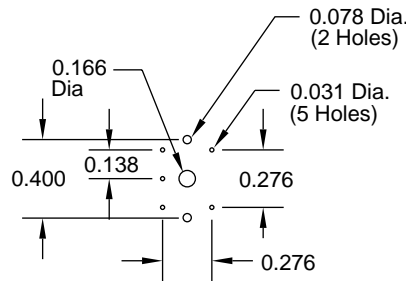
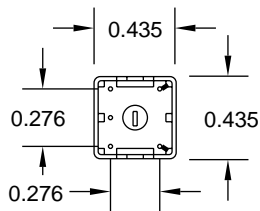
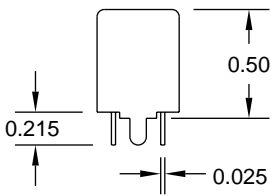

PC Board Layout