

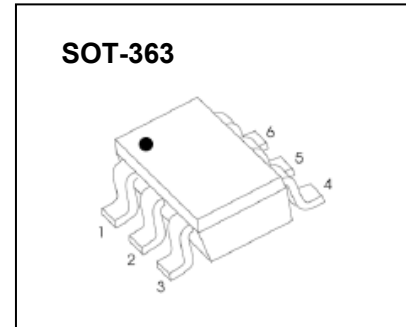

**SOT-363 Power Management MOSFETs-Schottky**

**CJ7203KDW** N-channel MOSFET and Schottky Barrier Diode

$V_{(BR)DSS}/V_R$	$R_{DS(on)MAX}$	$I_D/I_O$
60V	5Ω@10V	340mA
	5.3Ω@5V	
40V	/	350mA



**FEATURE**

- High density cell design for Low  $R_{DS(on)}$
- High saturation current capability
- Low Forward Voltage Drop
- Guard Ring Construction for Transient Protection
- Negligible Reverse Recovery Time
- Low Capacitance

**APPLICATION**

- Load Switch for Portable Devices
- DC/DC Converter

**MARKING**

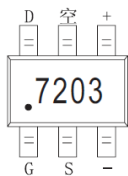

**Equivalent Circuit**

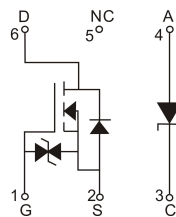

**MAXIMUM RATINGS ( $T_a=25^\circ\text{C}$  unless otherwise noted)**

Symbol	Parameter	Value	Unit
<b>B-MOSFET</b>			
$V_{DS}$	Drain-Source Voltage	60	V
$V_{GS}$	Gate-Source Voltage	±20	V
$I_D$	Continuous Drain Current	0.34	A
$I_{DM}^*$	Pulse Drain Current	1.36	A
<b>Schottky Barrier Diode</b>			
$V_{RRM}$	Peak Repetitive Reverse Voltage	40	V
$V_R$	DC Blocking Voltage	40	V
$I_O$	Average Rectified Forward Current	0.35	A
<b>Power Dissipation, Temperature and Thermal Resistance</b>			
$P_D$	Power Dissipation	0.15	W
$R_{\theta JA}$	Thermal Resistance from Junction to Ambient	833	$^\circ\text{C/W}$
$T_j$	Junction Temperature	150	$^\circ\text{C}$
$T_{stg}$	Storage Temperature	-55~+150	$^\circ\text{C}$
$T_L$	Lead Temperature for Soldering Purposes(1/8" from case for 10 s)	260	$^\circ\text{C}$

\*Repetitive rating: Pluse width limited by junction temperature.

## MOSFET ELECTRICAL CHARACTERISTICS

$T_a=25^\circ\text{C}$  unless otherwise specified

Parameter	Symbol	Test Condition	Min	Typ	Max	Units
<b>B-MOSFET</b>						
<b>Static Characteristics</b>						
Drain-Source Breakdown Voltage	$V_{DS}$	$V_{GS} = 0V, I_D = 250\mu A$	60			V
Gate Threshold Voltage*	$V_{GS(th)}$	$V_{DS} = V_{GS}, I_D = 1mA$	1	1.3	2.5	V
Zero Gate Voltage Drain Current	$I_{DSS}$	$V_{DS} = 48V, V_{GS} = 0V$			1	$\mu A$
Gate –Source leakage current	$I_{GSS1}$	$V_{GS} = \pm 20V, V_{DS} = 0V$			$\pm 10$	$\mu A$
	$I_{GSS2}$	$V_{GS} = \pm 10V, V_{DS} = 0V$			$\pm 200$	nA
	$I_{GSS3}$	$V_{GS} = \pm 5V, V_{DS} = 0V$			$\pm 100$	nA
Drain-Source On-Resistance*	$R_{DS(on)}$	$V_{GS} = 4.5V, I_D = 200mA$		1.1	5.3	$\Omega$
		$V_{GS} = 10V, I_D = 500mA$		0.9	5	$\Omega$
Diode Forward Voltage	$V_{SD}$	$V_{GS} = 0V, I_S = 300mA$			1.5	V
Recovered charge	$Q_r$	$V_{GS} = 0V, I_S = 300mA, V_R = 25V, di/dt = -100A/\mu S$		30		nC
<b>Dynamic Characteristics**</b>						
Input Capacitance	$C_{iss}$	$V_{DS} = 10V, V_{GS} = 0V, f = 1MHz$			40	pF
Output Capacitance	$C_{oss}$				30	pF
Reverse Transfer Capacitance	$C_{rss}$				10	pF
<b>Switching Characteristics**</b>						
Turn-On Delay Time	$t_{d(on)}$	$V_{GS} = 10V, V_{DD} = 50V, R_G = 50\Omega, R_{GS} = 50\Omega, R_L = 250\Omega$			10	ns
Turn-Off Delay Time	$t_{d(off)}$				15	ns
Reverse recovery Time	$t_{rr}$	$V_{GS} = 0V, I_S = 300mA, V_R = 25V, di/dt = -100A/\mu S$		30		ns
<b>GATE-SOURCE ZENER DIODE</b>						
Gate-Source Breakdown Voltage	$BV_{GSO}$	$I_{gs} = \pm 1mA$ (Open Drain)	$\pm 21.5$		$\pm 30$	V
<b>SCHOTTKY BARRIER DIODE</b>						
Reverse voltage	$V_{(BR)}$	$I_R = 100\mu A$	40			V
Reverse current	$I_R$	$V_R = 30V$			5	$\mu A$
Forward voltage	$V_F$	$I_F = 20mA$			0.37	V
		$I_F = 200mA$			0.6	
Total capacitance	$C_{tot}$	$V_R = 0V, f = 1MHz$		50		pF
Reverse recovery time	$t_{rr}$	$I_F = I_R = 200mA, I_{rr} = 0.1 \times I_R, R_L = 100\Omega$		10		ns

**Notes :**

\*Pulse Test : Pulse Width  $\leq 300\mu s$ , Duty Cycle  $\leq 2\%$ .

\*\*These parameters have no way to verify.

# Typical Characteristics

## N-channel Characteristics

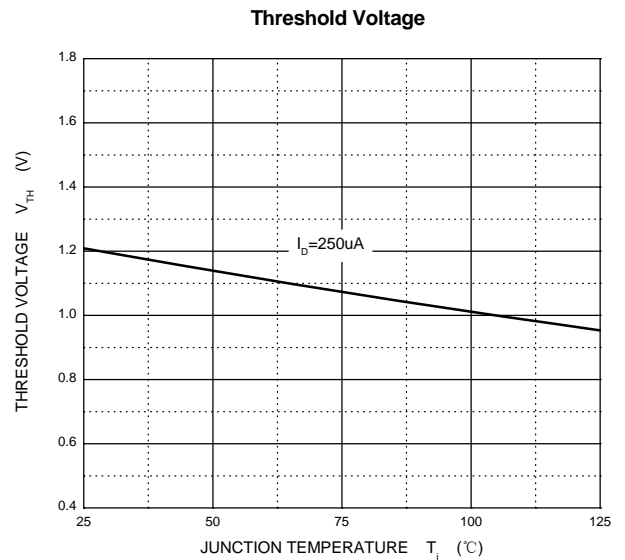
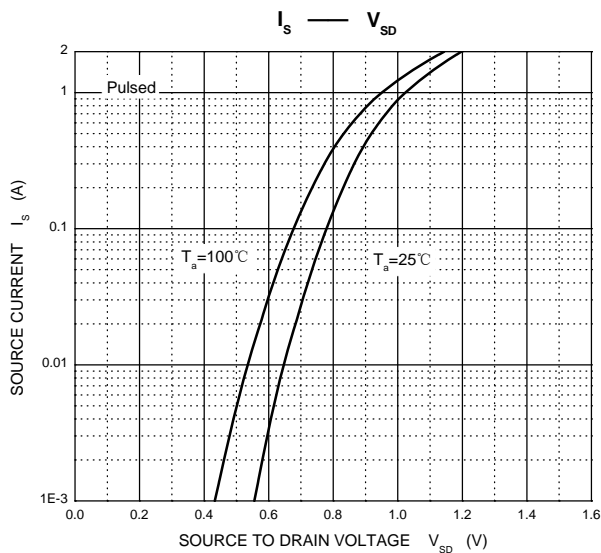
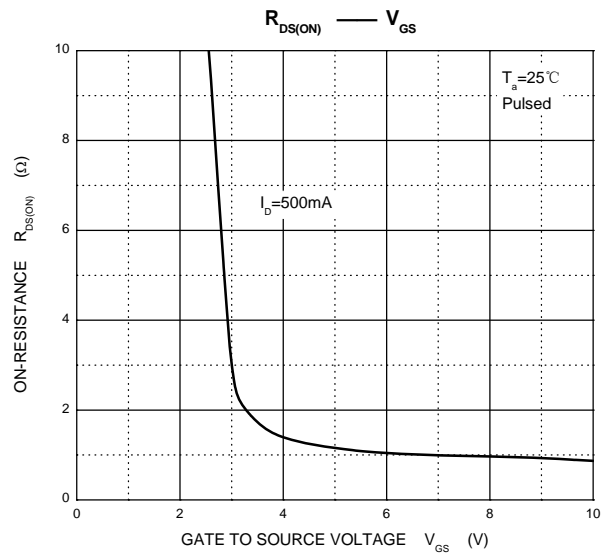
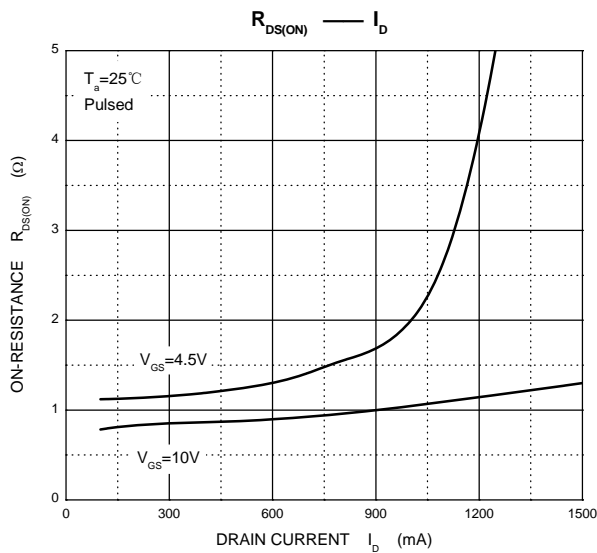
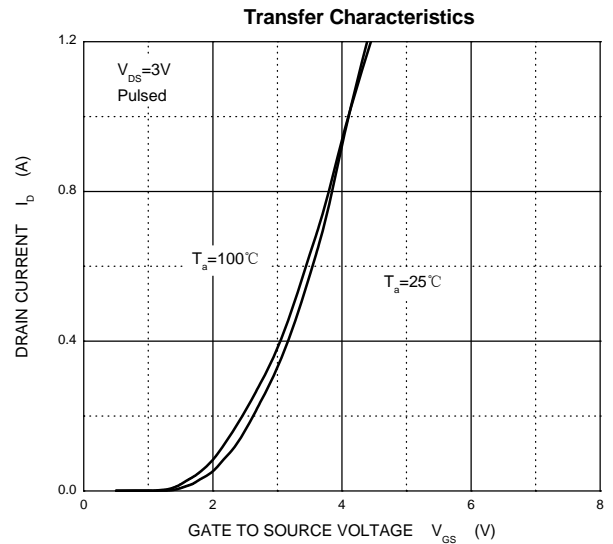
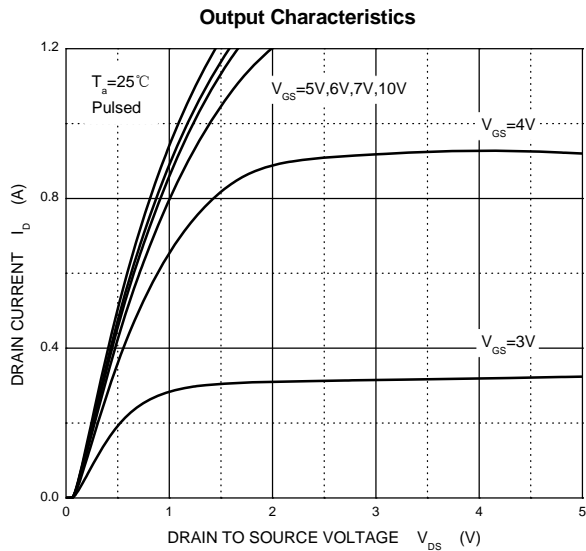

# Typical Characteristics

## Schottky Characteristics

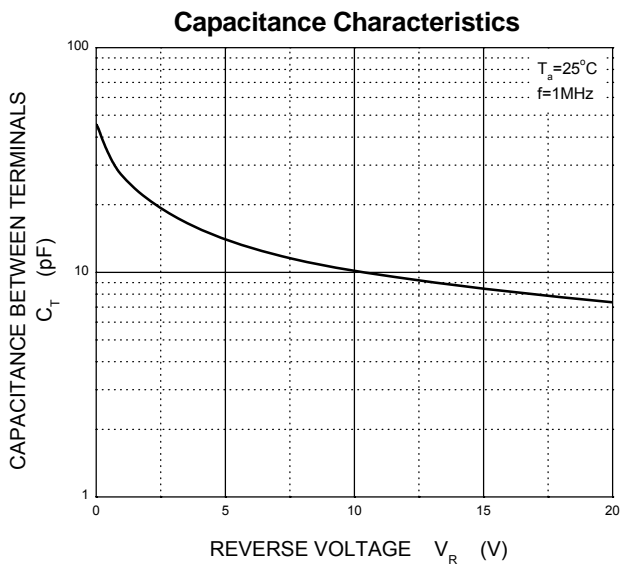
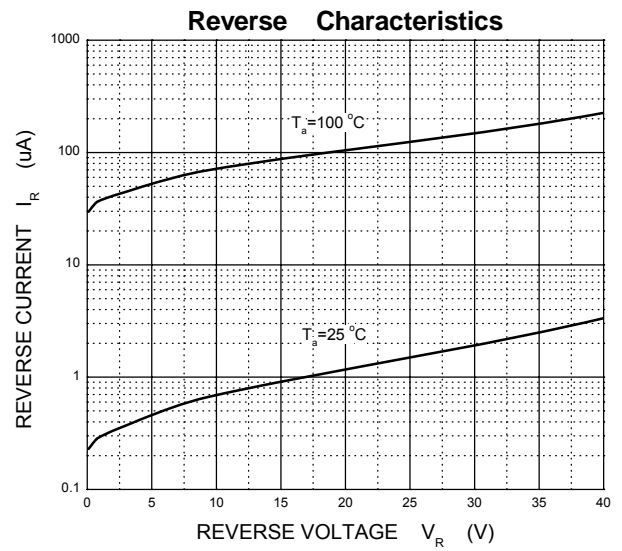
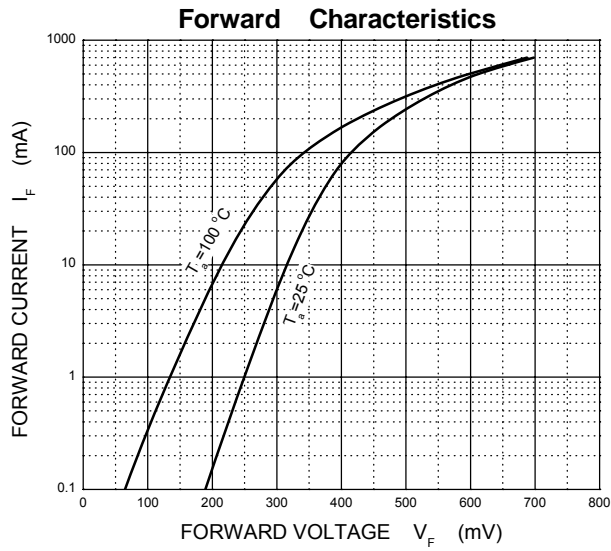

## SOT-363 Package Outline Dimensions

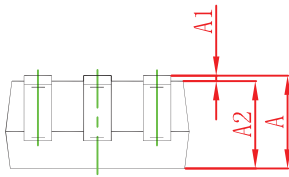
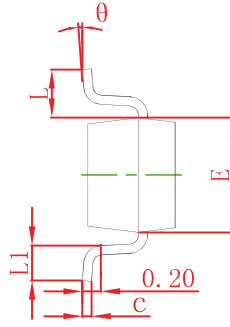
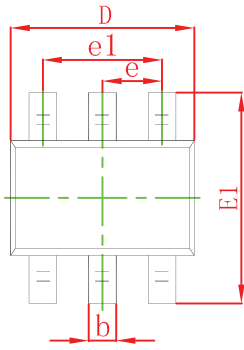

Symbol	Dimensions In Millimeters		Dimensions In Inches	
	Min	Max	Min	Max
A	0.900	1.100	0.035	0.043
A1	0.000	0.100	0.000	0.004
A2	0.900	1.000	0.035	0.039
b	0.150	0.350	0.006	0.014
c	0.100	0.150	0.004	0.006
D	2.000	2.200	0.079	0.087
E	1.150	1.350	0.045	0.053
E1	2.150	2.400	0.085	0.094
e	0.650 TYP		0.026 TYP	
e1	1.200	1.400	0.047	0.055
L	0.525 REF		0.021 REF	
L1	0.260	0.460	0.010	0.018
$\theta$	0°	8°	0°	8°

## SOT-363 Suggested Pad Layout

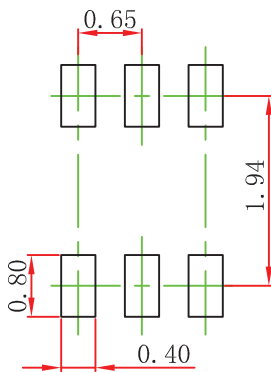

Note:

1. Controlling dimension: in millimeters.
2. General tolerance:  $\pm 0.05\text{mm}$ .
3. The pad layout is for reference purposes only.

### NOTICE

JCET reserve the right to make modifications, enhancements, improvements, corrections or other changes without further notice to any product herein. JCET does not assume any liability arising out of the application or use of any product described herein.

# SOT-363 Tape and Reel

## SOT-363 Embossed Carrier Tape

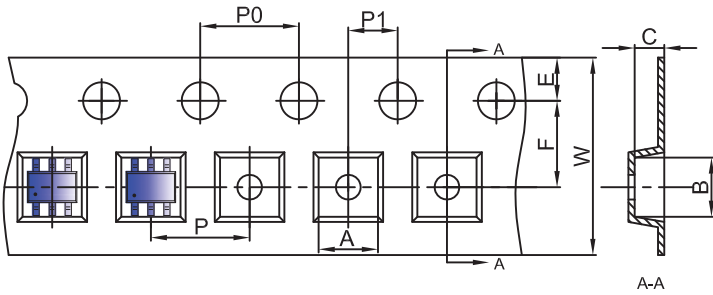

### Packaging Description:

SOT-363 parts are shipped in tape. The carrier tape is made from a dissipative (carbon filled) polycarbonate resin. The cover tape is a multilayer film (Heat Activated Adhesive in nature) primarily composed of polyester film, adhesive layer, sealant, and anti-static sprayed agent. These reeled parts in standard option are shipped with 3,000 units per 7" or 17.8cm diameter reel. The reels are clear in color and is made of polystyrene plastic (anti-static coated).

Dimensions are in millimeter										
Pkg type	A	B	C	d	E	F	P0	P	P1	W
SOT-363	2.25	2.55	1.20	Ø1.50	1.75	3.50	4.00	4.00	2.00	8.00

## SOT-363 Tape Leader and Trailer

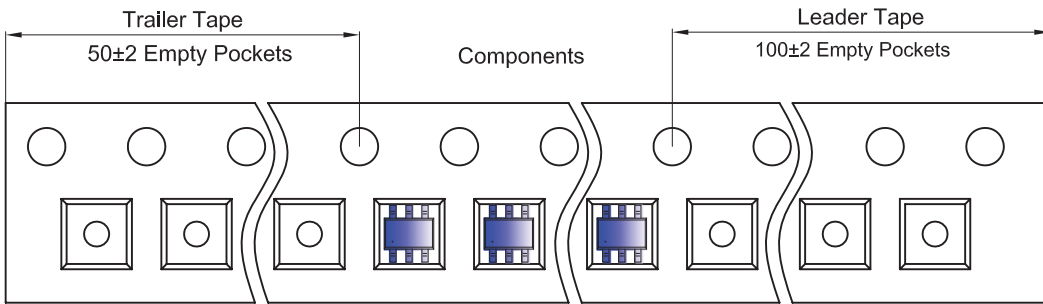

## SOT-363 Reel

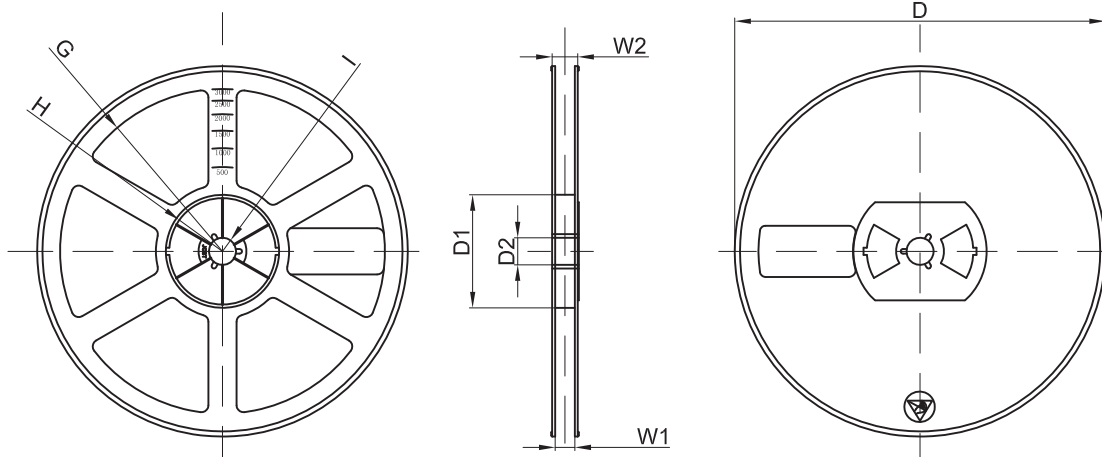

Dimensions are in millimeter								
Reel Option	D	D1	D2	G	H	I	W1	W2
7" Dia	Ø178.00	54.40	13.00	R78.00	R25.60	R6.50	9.50	12.30

REEL	Reel Size	Box	Box Size(mm)	Carton	Carton Size(mm)	G.W.(kg)
3000 pcs	7 inch	45,000 pcs	203×203×195	180,000 pcs	438×438×220	