

RECOMMENDED P.C.B. LAYOUT (SCALE 5:1)

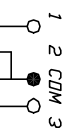
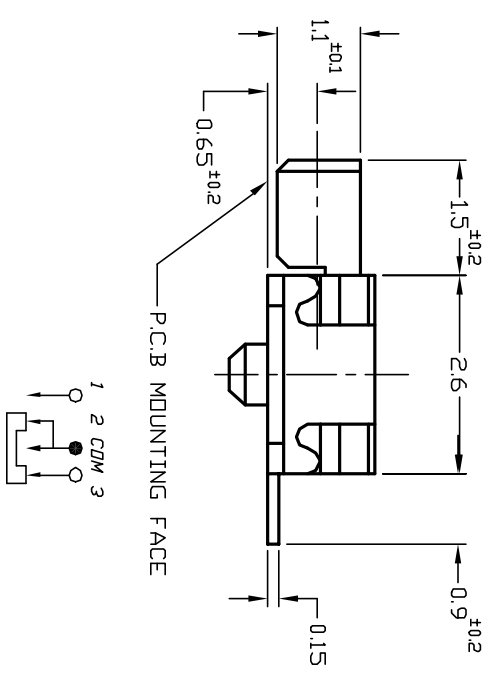
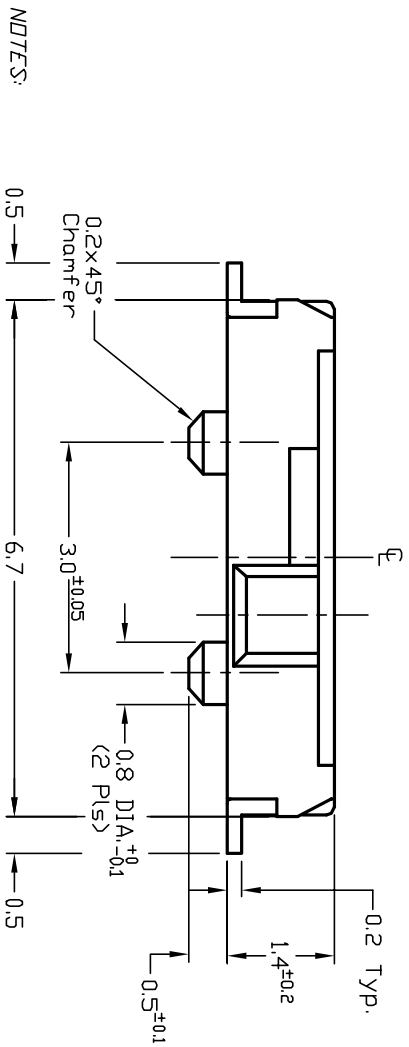

CIRCUIT: SP2T

CONTACT CONFIGURATION

- NOTES:
1. ALL DIMENSIONS IN MM
 2. TERM. NOS. FOR REF ONLY
 3. RATING: DC 4V, 0.3A
 4. OPERATING FORCE: 200±100gf
 5. CONTACT RESISTANCE: 70m Ohms Max.
 6. INSULATION RESISTANCE: DC 100V-100M Ohms Min
 7. WITHSTAND VOLTAGE: AC 100V-1MINUTE
 8. OPERATING TEMP: -20°C to +70°C
 9. LIFE: 10,000 Cycles min.

E	12175	ADD NOTE 8 & 9	CJB
D	11271	REMOVED DIMENSION	CJB
REV.	ECN No.	DESCRIPTION	DATE
		CHKD	

SCALE	10:1	DATE	8/27/97	DR	MM	DWG	P112221	REV	E
TITLE	E-SWITCH®								
TITLE	EG 1257								

THE INFORMATION CONTAINED IN THIS DOCUMENT IS PROPRIETARY TO E-SWITCH AND IS NOT TO BE COPIED OR TRANSFERRED