



Micro Commercial Corp.
 21201 Itasca St.
 Chatsworth, CA 91311
 Phone: (818) 701-4933
 Fax: (818) 701-4939

MP2505 THRU MP2510

Features

- Mounting Hole For #8 Screw
- Plastic Case With Metal Bottom
- Any Mounting Position
- Surge Rating Of 300 Amps

25 Amp Single Phase Bridge Rectifier 50 to 1000 Volts

Maximum Ratings

- Operating Temperature: -55°C to +150°C
- Storage Temperature: -55°C to +150°C

| MCC Catalog Number | Device Marking | Maximum Recurrent Peak Reverse Voltage | Maximum RMS Voltage | Maximum DC Blocking Voltage |
|--------------------|----------------|--|---------------------|-----------------------------|
| MP2505 | MP2505 | 50V | 35V | 50V |
| MP251 | MP251 | 100V | 70V | 100V |
| MP252 | MP252 | 200V | 140V | 200V |
| MP254 | MP254 | 400V | 280V | 400V |
| MP256 | MP256 | 600V | 420V | 600V |
| MP258 | MP258 | 800V | 560V | 800V |
| MP2510 | MP2510 | 1000v | 700V | 1000v |

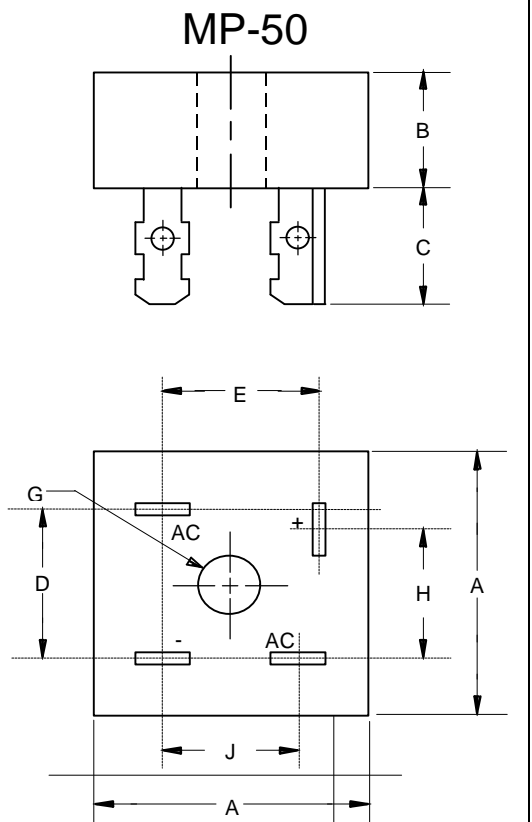

| DIM | INCHES | | MM | | NOTE |
|-----|--------|-------|-------|-------|------|
| | MIN | MAX | MIN | MAX | |
| A | 1.118 | 1.130 | 28.40 | 28.70 | |
| B | .432 | .442 | 10.97 | 11.23 | |
| C | .468 | .558 | 11.89 | 14.17 | |
| D | .689 | .728 | 17.50 | 18.50 | |
| E | .618 | .657 | 15.70 | 16.70 | |
| G | .193 | --- | 4.90 | --- | ∅ |
| H | .618 | .657 | 15.70 | 16.70 | |
| J | .531 | .571 | 13.50 | 14.50 | |

Electrical Characteristics @ 25°C Unless Otherwise Specified

| | | | |
|---|-------------|--------------------------------------|--|
| Average Forward Current | $I_{F(AV)}$ | 25.0A | $T_C = 55^\circ\text{C}$ |
| Peak Forward Surge Current | I_{FSM} | 300A | 8.3ms, half sine |
| Maximum Forward Voltage Drop Per Element | V_F | 1.1V | $I_{FM} = 12.5\text{A}$ per element; $T_J = 25^\circ\text{C}$ |
| Maximum DC Reverse Current At Rated DC Blocking Voltage | I_R | 5 μA 500 μA | $T_J = 25^\circ\text{C}$ $T_J = 125^\circ\text{C}$ |
| I^2t Rating for Fusing $t < 8.3\text{mS}$ | I^2t | 375 | A^2S |

*Pulse test: Pulse width 300 μsec , Duty cycle 1%

MP2505 thru MP2510

Figure 1
Typical Forward Characteristics

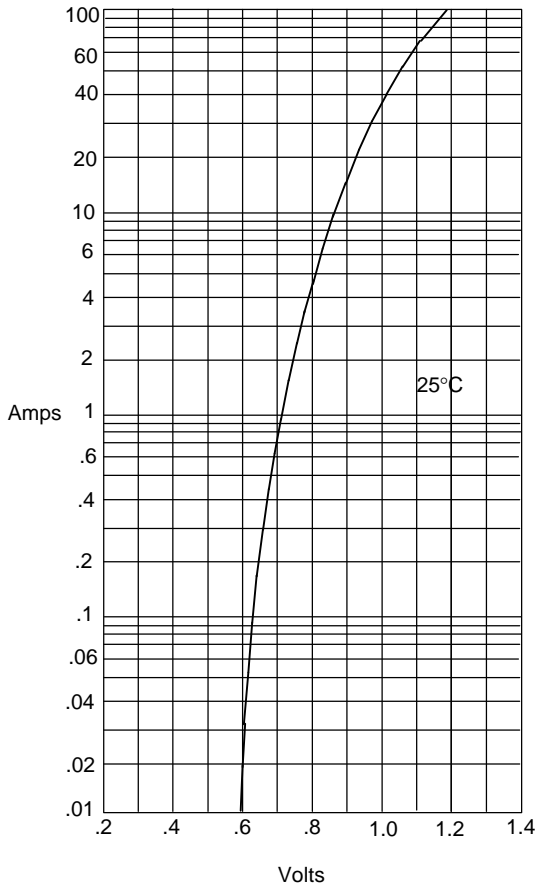

Instantaneous Forward Current - Amperes *versus*
Instantaneous Forward Voltage - Volts

Figure 2
Typical Reverse Characteristics

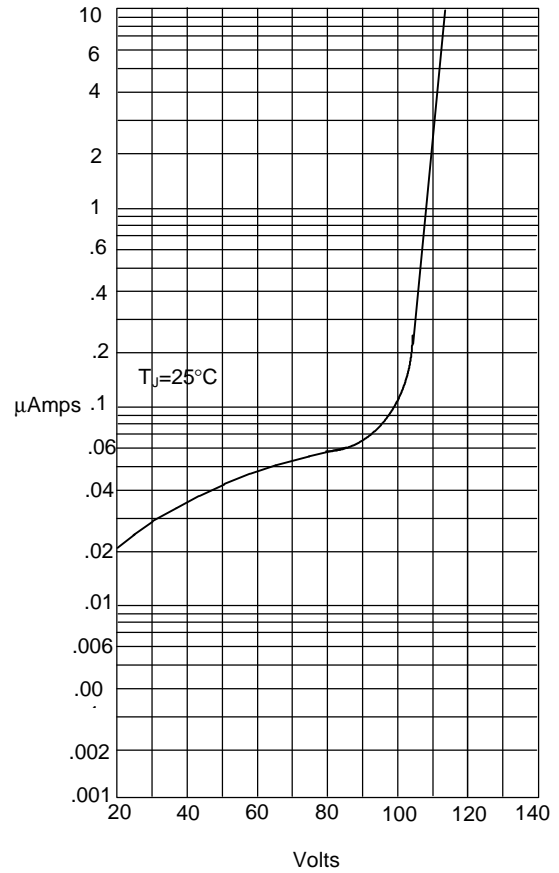

Instantaneous Reverse Leakage Current - MicroAmperes *versus*
Percent Of Rated Peak Reverse Voltage - Volts

Figure 3
Forward Derating Curve

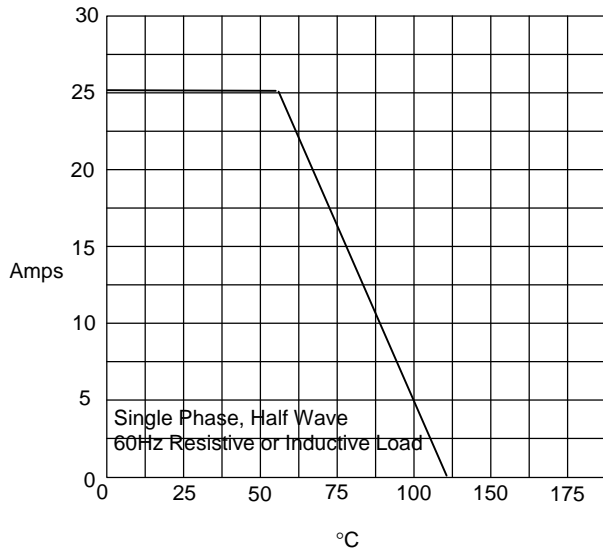

Average Forward Rectified Current - Amperes *versus*
Case Temperature - °C

Figure 4
Peak Forward Surge Current

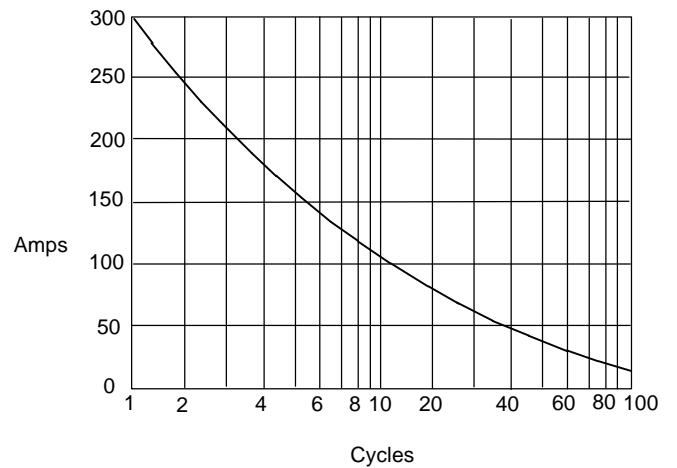

Peak Forward Surge Current - Amperes *versus*
Number Of Cycles At 60Hz - Cycles