

Micro Switches

8.6x4.8x3.0mm Superminiature Micro Switch

MP30 Series

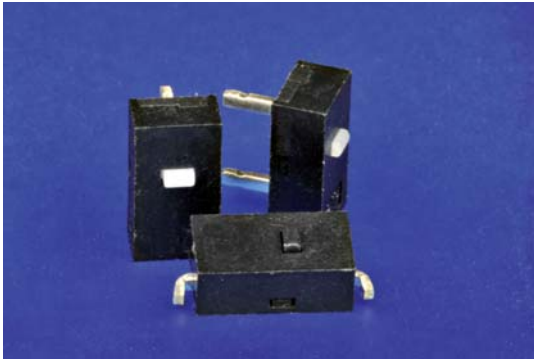

FEATURES

- > Smaller size than former superminiature micro switches
- > Longer operating life than former superminiature micro switches
- > THT and SMT terminal type

APPLICATIONS

- > Industrial Control
- > Notebook
- > Joystick
- > Computer mouse

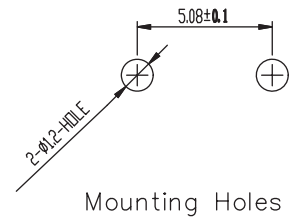
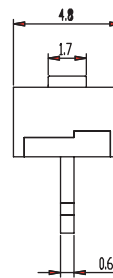
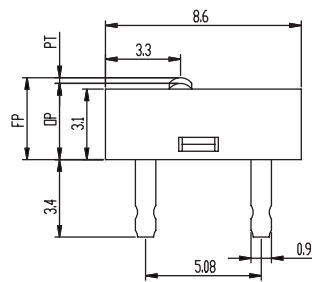

Mounting Holes

MP30R1H

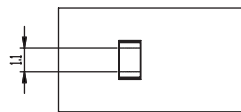

CONTACT CONFIGURATION

General Tolerance: ± 0.2 mm

Thru Hole Type

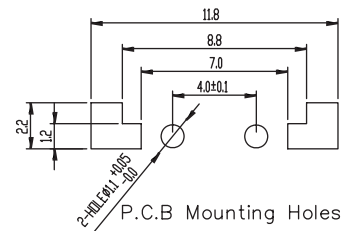
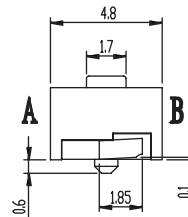
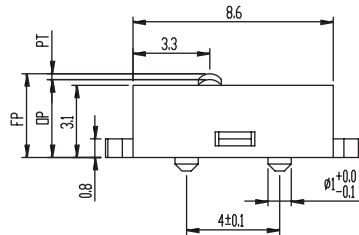

P.C.B Mounting Holes

MP30R1S

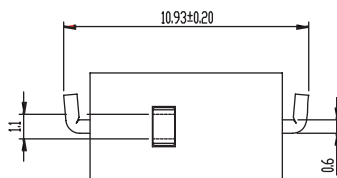

CONTACT CONFIGURATION

General Tolerance: ± 0.2 mm

Surface Mount Type

How to order:

MP30 1 2

- | | | | |
|----------|------------------------|----------|-------------------------------|
| 1 | CURRENT RATING: | 2 | TERMINAL (see drawing) |
| R1 | 0.1A 30VDC | H | THT |
| | | S | SMT |

1. Operation Characteristics

Operating Force (OF)	:	60±20 gf
Releasing Force (RF)	:	Min. 20 gf
Free Position (FP)	:	3.6±0.15 mm
Operating Position (OP)	:	3.35 $\begin{smallmatrix} +0.2 \\ -0.15 \end{smallmatrix}$ mm
Movement Differential (MD)	:	Max. 0.12 mm
Over-travel (OT)	:	Min. 0.1 mm
Pre-travel (PT)	:	Max. 0.65 mm

2. Specifications

Contact Resistance	:	Max. 100 mΩ. (Initial) Before measure the switch contact resistance, please press the switch three times on and off.
Dielectric Strength	:	600VAC (50-60HZ) for one minute between contacts and live-parts
Insulation Resistance	:	Min. 100 MΩ (At 500 VDC for 1 minute)
Circuit Arrangement	:	SPST (Single pole single throw)
Rating	:	0.1A 30VDC
Service Life	:	Min. 3,000,000 operations
Rating Load	:	Resistive Load
Operating Frequency	:	120 operations per minute
Mechanical Service Life	:	Min. 3,000,000 operations.
Operating Frequency	:	Max. 120 operations per minute

3. Environments

Operating Temperature	:	-25°C ~ 70°C
Storage Temperature	:	-40°C ~ 85°C
Storage Humidity	:	at 40°C, Max. 85% R.H
Vibration	:	10~55Hz, displacement 0.75mm(p-p)
For SMT Temperature	:	Max. 250 °C for 10 seconds, please see the enclosed drawing

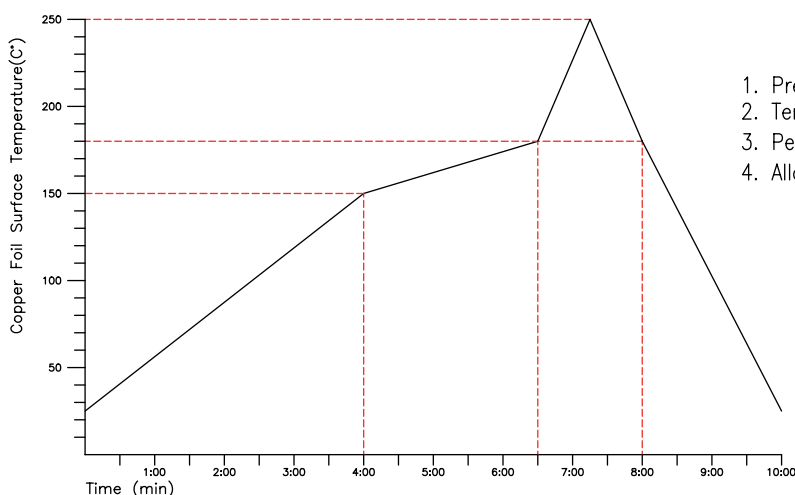

1. Preheat Temp. 150~180°C, Time 1.5~2.5 min.
2. Temp. over 180°C, Time Max. 1.5 min.
3. Peak Temp. Max. 250°C, Time Max. 10 sec.
4. Allowable frequency of solder 2 times.