

# MS-214-3 Miniature Reed Sensor



## Electrical Characteristics

<b>Contact form</b>		A
<b>Contact rating max.</b>	W / VA	10
<b>Switching current max.</b>	A	0.7
<b>Carry current max.</b>	A	1.0
<b>Switching voltage max.</b>	VDC	180
	VAC	130
<b>Breakdown voltage min.</b>	VDC	200
<b>Contact resistance (initial) max.</b>	mΩ	100
<b>Insulation resistance min.</b>	Ω	10 <sup>9</sup>
<b>Capacitance typ.</b>	pF	0.5

## Magnetical Characteristics

<b>Pull in range available <sup>1</sup></b>	AT	10-25
---------------------------------------------	----	-------

<sup>1</sup> AT range stated for **unmodified** Reed Switch

## Operating Characteristics

<b>Operate time (incl. bounce) max.</b>	ms	0.5
<b>Release time max.</b>	ms	0.3
<b>Switching frequency max.</b>	Hz	500
<b>Resonant frequency typ.</b>	Hz	5,000
<b>Vibration (50-2000 Hz)</b>	g	20
<b>Shock (1/2 sin 11 ms)</b>	g	50
<b>Operating temperature</b>	°C	-40 to +85

## Dimensions

in mm

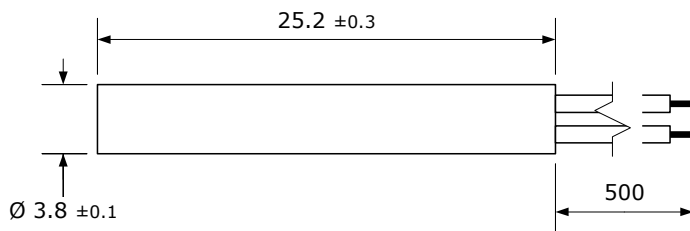

Wire: AWG 26, black, stripped and tinned

## Ordering Information

Series	AT Range
MS-214-3	<b>1</b> = 10-15 / <b>2</b> = 15-20 / <b>3</b> = 20-25

**Ordering example:** MS-214-3-2 describes MS-214-3 with 15-20 AT

**Customized types available.**