



## MS-228-3 Reed Sensor • M8 thread

### Electrical Characteristics

Contact form		A
Contact rating max.	W / VA	10
Switching current max.	A	1.0
Carry current max.	A	1.2
Switching voltage max.	VDC	200
	VAC	140
Breakdown voltage min.	VDC	240
Contact resistance (initial) max.	mΩ	100
Insulation resistance min.	Ω	10 <sup>10</sup>
Capacitance typ.	pF	0.5

### Magnetical Characteristics

Pull in range available <sup>1</sup>	AT	10-25
--------------------------------------	----	-------

<sup>1</sup> AT range stated for unmodified Reed Switch

### Operating Characteristics

Operate time (incl. bounce) max.	ms	1.0
Release time max.	ms	0.4
Switching frequency max.	Hz	500
Resonant frequency typ.	Hz	4,000
Vibration (50-2000 Hz)	g	20
Shock (1/2 sin 11 ms)	g	100
Operating temperature	°C	-20 to +85

### Dimensions

in mm

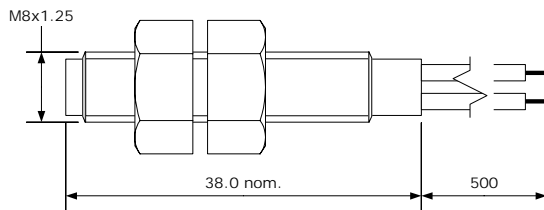

Wire: AWG 24, black, stripped and tinned

### Ordering Information

Series	AT Range
MS-228-3	1 = 10-15 / 2 = 15-20 / 3 = 20-25

Ordering example: MS-228-3-2 describes MS-228-3 with 15-20 AT

Customized types available.

## MS-228-3

### Reed Sensor • M8 thread



### Matching Actuator MSM-228

in mm

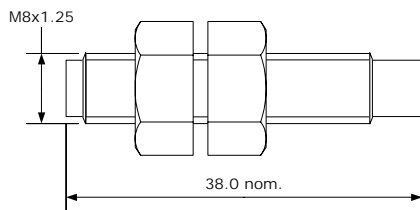

Customized types and other magnet orientations available.