



MS-328-6 Power Reed Sensor • Flatpack

Electrical Characteristics

Contact form		A
Contact rating max.	W / VA	50
Switching current max.	A	1.5
Carry current max.	A	2.0
Switching voltage max.	VDC	200
	VAC	250
Breakdown voltage min.	VDC	400
Contact resistance (initial) max.	mΩ	100
Insulation resistance min.	Ω	10 ¹⁰
Capacitance typ.	pF	0.5

Magnetical Characteristics

Pull in range available ¹	AT	25-40
--------------------------------------	----	-------

¹ AT range stated for unmodified Reed Switch

Operating Characteristics

Operate time (incl. bounce) max.	ms	1.0
Release time max.	ms	0.4
Switching frequency max.	Hz	300
Resonant frequency typ.	Hz	2,600
Vibration (50-2000 Hz)	g	20
Shock (1/2 sin 11 ms)	g	50
Operating temperature	°C	-20 to +85

Dimensions

in mm

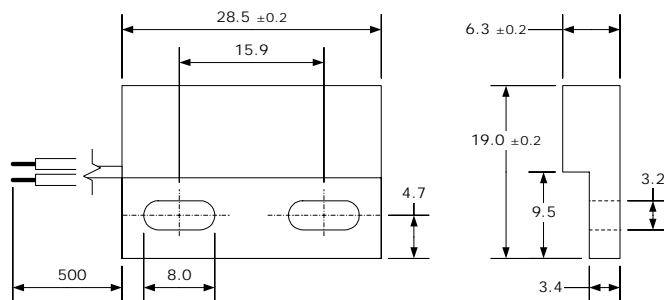

Wire: AWG 20, black, stripped and tinned

Ordering Information

Series	AT Range
MS-328-5	4 = 25-30 / 5 = 30-35 / 6 = 35-40

Ordering example: MS-328-6-4 describes MS-328-6 with 25-30 AT

Customized types available.

MS-328-6

Power Reed Sensor • Flatpack



Matching Actuator MSM-328

in mm

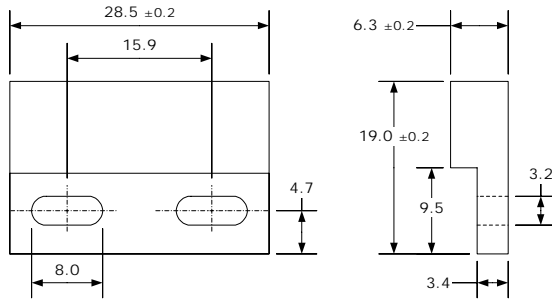

Customized types and other magnet orientations available.