

5.0" 5x8 Dot Matrix Display

FEATURES

- 5.0" 5x8 dot matrix
- Additional colors/materials available

OPTO-ELECTRICAL CHARACTERISTICS (Ta = 25°C)

| PART NO. | PEAK WAVE LENGTH (nm) | EMITTED COLOR | FACE COLORS | | MAXIMUM RATINGS | | | OPTO-ELECTRICAL CHARACTERISTICS | | | | | | PIN-OUT | |
|---------------|-----------------------|---------------|---------------|-------------|-----------------|--------|---------|---------------------------------|------|-----|--------|-----|--------------|---------|-----|
| | | | SURFACE COLOR | EPOXY COLOR | IF (mA) | VR (V) | PD (mW) | VF(V) | | | IR(μA) | | IV(μcd) | | |
| | | | | | | | | typ. | max. | @mA | max. | @VR | typ. per dot | | @mA |
| MTAN2146-AG | 567 | Green | Grey | White | 30 | 5 | 85 | 4.2 | 6.0 | 20 | 100 | 5 | 6800 | 10 | 1 |
| MTAN4146-AO | 635 | Orange | Grey | White | 30 | 5 | 85 | 4.2 | 6.0 | 20 | 100 | 5 | 7800 | 10 | 1 |
| MTAN4146-AHR | 635 | Hi-Eff Red | Red | Red | 30 | 5 | 85 | 4.2 | 6.0 | 20 | 100 | 5 | 7800 | 10 | 1 |
| MTAN7146M-12A | 660 | Ultra Red | Black | White | 30 | 4 | 70 | 3.4 | 4.4 | 20 | 100 | 4 | 41100 | 20 | 1 |
| MTAN2146-CG | 567 | Green | Grey | White | 30 | 5 | 85 | 4.2 | 6.0 | 20 | 100 | 5 | 6800 | 10 | 2 |
| MTAN4146-CO | 635 | Orange | Grey | White | 30 | 5 | 85 | 4.2 | 6.0 | 20 | 100 | 5 | 7800 | 10 | 2 |
| MTAN4146-CHR | 635 | Hi-Eff Red | Red | Red | 30 | 5 | 85 | 4.2 | 6.0 | 20 | 100 | 5 | 7800 | 10 | 2 |
| MTAN7146M-22C | 660 | Ultra Red | Black | White | 30 | 4 | 70 | 3.4 | 4.4 | 20 | 100 | 4 | 41100 | 20 | 2 |

Operating Temperature: -25~+85, Storage Temperature: -25~+100. Other face/epoxy colors are available.

PACKAGE DIMENSIONS AND PIN FUNCTIONS

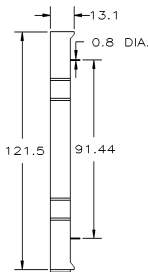
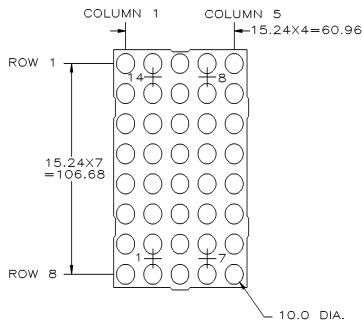

PINOUT 1

COLUMN ANODE

PIN NO. FUNCTION

1. CATHODE ROW 6
2. ANODE COLUMN 1
3. CATHODE ROW 8
4. CATHODE ROW 5
5. ANODE COLUMN 3
6. CATHODE ROW 4
7. CATHODE ROW 7
8. ANODE COLUMN 4
9. ANODE COLUMN 5
10. ANODE COLUMN 3
11. ANODE COLUMN 2
12. CATHODE ROW 1
13. CATHODE ROW 2
14. CATHODE ROW 3

PINOUT 2

COLUMN CATHODE

PIN NO. FUNCTION

1. ANODE ROW 6
2. CATHODE COLUMN 1
3. ANODE ROW 8
4. ANODE ROW 5
5. CATHODE COLUMN 3
6. ANODE ROW 4
7. ANODE ROW 7
8. CATHODE COLUMN 4
9. CATHODE COLUMN 5
10. CATHODE COLUMN 3
11. CATHODE COLUMN 2
12. ANODE ROW 1
13. ANODE ROW 2
14. ANODE ROW 3

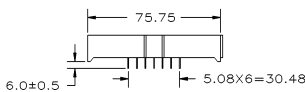

1. ALL DIMENSIONS ARE IN mm, TOLERANCE IS ±0.25mm UNLESS OTHERWISE SPECIFIED.
2. THE SLOPE ANGLE OF ANY PIN MAY BE ±5.0° MAX.



120 Broadway • Menands, New York 12204

Toll Free: (800) 98-4LEDS • Fax: (518) 432-7454

For up-to-date product info visit our web site at www.marktechopto.com

All specifications subject to change.