



Model Number

NMB2-12GM65-E0-NFE-V1

Features

- Stainless steel sensing face
- Sensing range 2 mm
- 3-wire DC
- Nonferrous targets

Connection

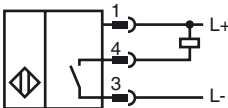

Pinout

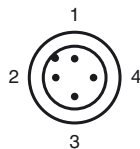

Wire colors in accordance with EN 60947-5-2

| | | |
|---|----|---------|
| 1 | BN | (brown) |
| 2 | WH | (white) |
| 3 | BU | (blue) |
| 4 | BK | (black) |

Accessories

- V1-G-OR2M-POC**
Female cordset, M12, 4-pin, TPE cable, welding-bead resistant
- V1-W-2M-PUR**
Cable socket, M12, 4-pin, PUR cable
- V1-G-2M-PUR**
Cable socket, M12, 4-pin, PUR cable
- AB-12**
Mounting aid

Dimensions

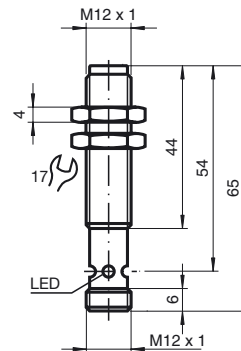

Technical Data

General specifications

| | | |
|------------------------------|-------|--------------------|
| Switching element function | NPN | NO |
| Rated operating distance | s_n | 2 mm |
| Installation | | flush |
| Output polarity | | DC |
| Assured operating distance | s_a | 0 ... 1.62 mm |
| Actuating element | | Nonferrous targets |
| Reduction factor r_{Al} | | 1 |
| Reduction factor r_{Cu} | | 1.1 |
| Reduction factor r_{304} | | 0 |
| Reduction factor r_{S137} | | 0 |
| Reduction factor r_{Brass} | | 0.9 |

Nominal ratings

| | | |
|-----------------------------|-------|----------------------------|
| Operating voltage | U_B | 10 ... 30 V DC |
| Switching frequency | f | 15 Hz |
| Hysteresis | H | 3 ... 15 typ. 5 % |
| Reverse polarity protection | | reverse polarity protected |
| Short-circuit protection | | pulsing |
| Voltage drop | U_d | ≤ 2 V DC |
| Operating current | I_L | ≤ 200 mA |
| Current consumption | | < 14 mA |
| Off-state current | I_r | ≤ 10 μ A |

Indicators/operating means

| | |
|-------------------|----------------|
| Operating display | 4-way dual LED |
| | Green: power |
| | Yellow: output |

Ambient conditions

| | |
|---------------------|--------------------------------|
| Ambient temperature | -40 ... 70 °C (-40 ... 158 °F) |
|---------------------|--------------------------------|

Mechanical specifications

| | |
|-------------------|--|
| Connection type | V1 connector (M12 x 1), 4-pin |
| Housing material | Stainless steel 1.4305 / AISI 303 |
| Sensing face | Stainless steel 1.4305 / AISI 303 |
| Protection degree | IP67 / IP68 / IP69K - cordset dependent according to cable specification |

Compliance with standards and directives

| | |
|---------------------|---|
| Standard conformity | |
| Standards | EN 60947-5-2:2007 IEC 60947-5-2:2007 |

Approvals and certificates

| | |
|--------------|--|
| UL approval | cULus Listed, General Purpose |
| CSA approval | cCSAus Listed, General Purpose |
| CCC approval | Products with a maximum operating voltage of ≤ 36 V do not bear a CCC marking because they do not require approval. |