



R1200F THRU R3000F

HIGH VOLTAGE FAST TRCOVERY RECTIFIER

VOLTAGE: 1200-3000V

CURRENT: 0.2 to 0.5A

FEATURES

- Fast switching
- Low leakage
- High current capability
- High surge capability
- High reliability

MECHANICAL DATA

- **Case:** Molded plastic
- **Epoxy:** UL94V-0 rate flame retardant
- **Lead:** MIL-STD- 202E, Method 208 guaranteed
- **Polarity:** Color band denotes cathode end
- **Mounting position:** Any
- **Weight:** 0.35 grams

DO-41

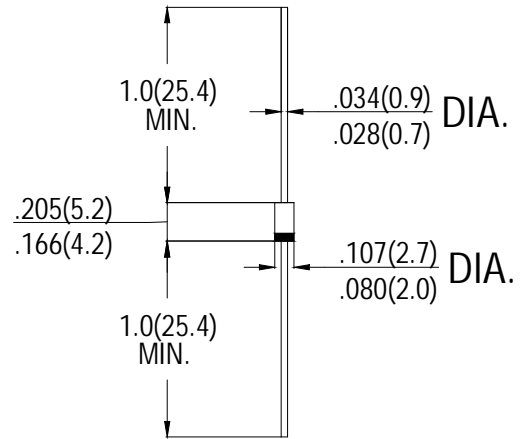

Dimensions in inches and (millimeters)

MAXIMUM RATINGS AND ELECTRICAL CHARACTERISTICS

Ratings at 25°C ambient temperature unless otherwise specified.
Single phase, half wave, 60Hz, resistive or inductive load.
For capacitive load, derate current by 20%.

	SYMBOL	R1200F	R1500F	R1800F	R2000F	R2500F	R3000F	units
Maximum Recurrent Peak Reverse Voltage	V_{RRM}	1200	1500	1800	2000	2500	3000	V
Maximum RMS Voltage	V_{RMS}	840	1050	1260	1400	1750	2100	V
Maximum DC Blocking Voltage	V_{DC}	1200	1500	1800	2000	2500	3000	V
Maximum Average Forward rectified Current at $T_A=50^\circ C$	I_o	0.5			0.2			A
Peak Forward Surge Current 8.3ms single half sine-wave superimposed on rate load (JEDEC method)	I_{FSM}	30						A
Maximum Forward Voltage Drop per element at 0.5/0.2A DC	V_F	2.5			4.0	5.0		V
Maximum DC Reverse Current at Rated DC Blocking Voltage $T_A=25^\circ C$	I_R	5.0						μA
Maximum Full Load Reverse Current Average, Full Cycle .375"(9.5mm) lead length at $T_L=75^\circ C$		100						
Maximum Reverse Recovery Time (Note)	t_{rr}	500						nS

Notes: Test Conditions: $I_F=0.5A$, $I_R=1.0A$, $I_{RR}=0.25A$