

Molded Precision Wirewound Resistors Axial Leads

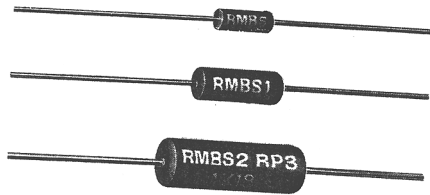

FEATURES

- 0.75 W to 3 W at 25 °C
- NF C 83-210
- CECC 40201-005
- Low temperature coefficient $\leq \pm 50$ ppm/°C
- Low ohmic values 15 mΩ available
- Excellent behavior against humidity
- Electrical insulation
- Mechanical strength
- Accurate sizes
- Termination = Sn/Ag/Cu or pure matte tin according to the ohmic value



RoHS
COMPLIANT

High stability and low temperature coefficient are the main features of the precision wirewound resistors type RMB RMBS models just as maintenance parts. Their performances can be compared with those of the best film resistors but they have in addition a greater power rating. RMBS styles meet the more severe requirements of NF C 83-210 (all RMBS styles are approved) and characteristic U of MIL-R-26 E (approximate size of RW 70 and 79 resistors) specifications. The two models RMB and RMBS have a similar construction. RMBS are submitted, in addition to a process which further increases the stability. On request, non-inductive resistors are available under the reference RMB NI.

DIMENSIONS in millimeters

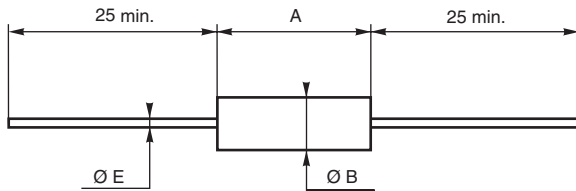

SERIES AND STYLE	RMB 0.75 RMBS 0.5	RMB 1.5 RMBS 1	RMB 3 RMBS 2
A max.	7	10.2	16.2
Ø B max.	2.5	4	6.4
E ± 0.1	0.6	0.6	0.8
Weight in g	0.3	0.7	1.5

TECHNICAL SPECIFICATIONS							
VISHAY SFERNICE SERIES AND STYLE	RMB 0.75	RMB 1.5	RMB 3	RMBS 0.5	RMBS 1	RMBS 2	
NF C 83-210	-	-	-	RP1	RP2	RP3	
CECC 40201-005	-	-	-	A	B	C	
Power Rating	at 25 °C	0.75 W	1.5 W	3 W	0.5 W	1 W	2 W
	at 70 °C	0.6 W	1.2 W	2.4 W	0.4 W	0.8 W	1.6 W
Ohmic Range in Relation to Tolerance	$\pm 5\%$ E24	0.1 Ω 2 kΩ	0.1 Ω 6.81 kΩ	0.051 Ω 13 kΩ	0.1 Ω 2 kΩ	0.1 Ω 6.81 kΩ	0.015 Ω 13 kΩ
	$\pm 2\%$ E48	0.1 Ω 2 kΩ	0.1 Ω 6.81 kΩ	0.08 Ω 12.3 kΩ	0.1 Ω 2 kΩ	0.1 Ω 6.81 kΩ	0.078 Ω 12.4 kΩ
	$\pm 1\%$ E96	0.1 Ω 2 kΩ	0.1 Ω 6.81 kΩ	0.1 Ω 12.4 kΩ	0.1 Ω 2 kΩ	0.1 Ω 6.81 kΩ	0.1 Ω 12.4 kΩ
	$\pm 0.5\%$ E96	0.4 Ω 2 kΩ	0.4 Ω 6.81 kΩ	0.3 Ω 12.4 kΩ	0.4 Ω 2 kΩ	0.4 Ω 6.81 kΩ	0.3 Ω 12.4 kΩ
	$\pm 0.1\%$	Please consult VISHAY SFERNICE					
Qualified Ohmic Range NF C 83-210	-	-	-	1 Ω 174 Ω	1 Ω 590 Ω	1 Ω 1.3 kΩ	
Limiting Element Voltage	not applicable	120 V	200 V	not applicable	120 V	200 V	
Critical Resistance	out of nominal ohmic range						

Undergoes European Quality Insurance System (CECC)



Disclaimer

All product specifications and data are subject to change without notice.

Vishay Intertechnology, Inc., its affiliates, agents, and employees, and all persons acting on its or their behalf (collectively, "Vishay"), disclaim any and all liability for any errors, inaccuracies or incompleteness contained herein or in any other disclosure relating to any product.

Vishay disclaims any and all liability arising out of the use or application of any product described herein or of any information provided herein to the maximum extent permitted by law. The product specifications do not expand or otherwise modify Vishay's terms and conditions of purchase, including but not limited to the warranty expressed therein, which apply to these products.

No license, express or implied, by estoppel or otherwise, to any intellectual property rights is granted by this document or by any conduct of Vishay.

The products shown herein are not designed for use in medical, life-saving, or life-sustaining applications unless otherwise expressly indicated. Customers using or selling Vishay products not expressly indicated for use in such applications do so entirely at their own risk and agree to fully indemnify Vishay for any damages arising or resulting from such use or sale. Please contact authorized Vishay personnel to obtain written terms and conditions regarding products designed for such applications.

Product names and markings noted herein may be trademarks of their respective owners.