

**Tyco / Electronics**  
**Raychem Circuit Protection**  
 308 Constitution Drive  
 Menlo Park, CA 94025-1164  
 Phone: 800-227-4856  
 Fax: 800-227-4866

**PolySwitch®**  
**PTC Devices**  
 Overcurrent Protection Device

**PRODUCT: TR600-150**

DOCUMENT: SCD 22231  
 PCN: 050889  
 REV LETTER: L  
 REV DATE: MAY 15, 2003  
 PAGE NO.: 1 OF 1

**Specification Status: Released**

**Max Electrical Rating at 20°C**

**Operating Voltage: 60V<sub>DC</sub>**  
**Fault Voltage: 600V<sub>RMS</sub>**  
**Interrupt Current: 3A<sub>RMS</sub>**

Lead Material:  
 22 AWG Sn/Pb plated copper

**Marking:**

Raychem Logo and Voltage  
 X 600  
 150 — Part Identification  
 □ □ □ □ — Lot Identification

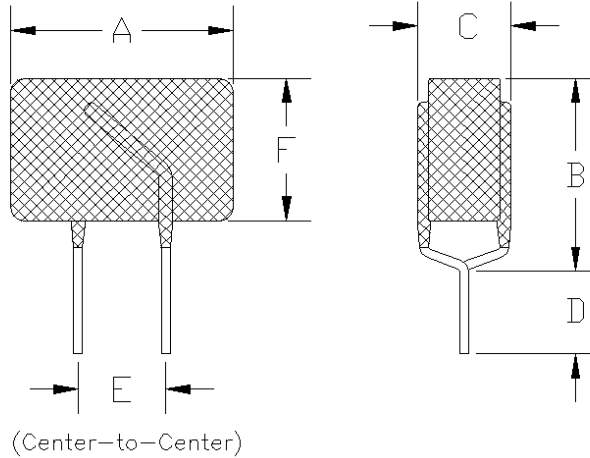

**TABLE I. DIMENSIONS:**

	A		B		C		D		E	F
	MIN	MAX	MIN	MAX	MIN	MAX	MIN	MAX	NOM	MAX
mm:	--	13.5	--	12.6	--	6.0	4.7	--	5.0	10.0
in:	--	(0.531)	--	(0.496)	--	(0.236)	(0.185)	--	(0.197)	(0.394)

**TABLE II. PERFORMANCE RATINGS @ 20°C (unless otherwise noted):**

IHOLD (A)		RESISTANCE (Ω)			TIME TO TRIP (s) @ 1A		OPERATING TEMPERATURE (°C)	
20°C	60°C	R MIN	R MAX	R <sub>1 MAX</sub> *	TYP	MAX	MIN	MAX
0.150	0.096	6.0	12.0	22.0	5.0	8.0	-40	85

\*Maximum device resistance at 20°C measured 1hour post trip.

Agency Recognition: UL, CSA  
 Reference Documents: PS300  
 Precedence: This specification takes precedence over documents referenced herein.  
 Effectivity: Reference documents shall be the issue in effect on the date of invitation for bid.  
 CAUTION: Operation beyond the rated voltage or current may result in rupture, electrical arcing or flame.