

200mA Low Profile Chip Schottky Rectifier

Features

- Low profile with SMD package
- Low power loss , High efficiency
- High current capability, Low voltage drop
- Plastic package has Underwriters Laboratory Flammability Classification 94V-0
- RoHS compliant

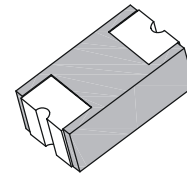

C0603
(SOD-523)



Mechanical Data

Case:	0603 SMD package, Molded plastic body
Terminals:	Pure Tin plated, solderable per MIL-STD-750, Method 2026
Polarity	Laser cathode band marking
Weight:	0.003 gram

Maximum Ratings *(T_{Ambient}=25°C unless noted otherwise)*

Symbol	Description	TSCD022 WT	TSCD022 WTR	TSCD024 WT	TSCD024 WTR	Unit	Conditions
	Marking Code	2D	2D1	4D	4D1		
VRRM	Maximum Repetitive Peak Reverse Voltage	20		40		V	
VRWM	Maximum Working Peak Reverse Voltage	20		40		V	
IF(AV)	Forward Rectified Current	200				mA	
IFSM	Non-repetitive Peak Forward Surge Current	2.0				A	8.3ms single half sine-wave
TJ	Operating Junction temperature range	-40 to +125				°C	
TSTG	Storage Temperature Range	-40 to +125				°C	

Electrical Characteristics *(T_{Ambient}=25°C unless noted otherwise)*

Symbol	Description	TSCD022 WT	TSCD022 WTR	TSCD024 WT	TSCD024 WTR	Unit	Conditions
VF	Maximum Instantaneous Forward Voltage Drop	0.45				V	IF= 0.2A
IR	Maximum DC Reverse Current at Rated DC Blocking Voltage	50	1*	50	1*	µA	* VR=10V

200mA Low Profile Chip Schottky Rectifier

TSCD022WT-TSCD024WTR

Typical Characteristics Curves

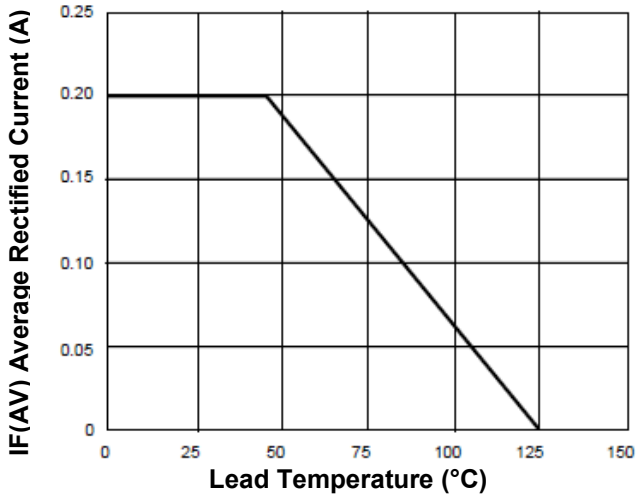

Fig.1- Forward Current Derating Curve

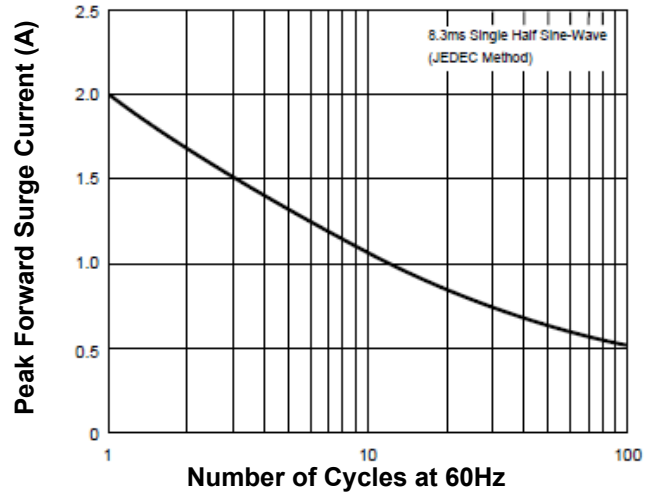
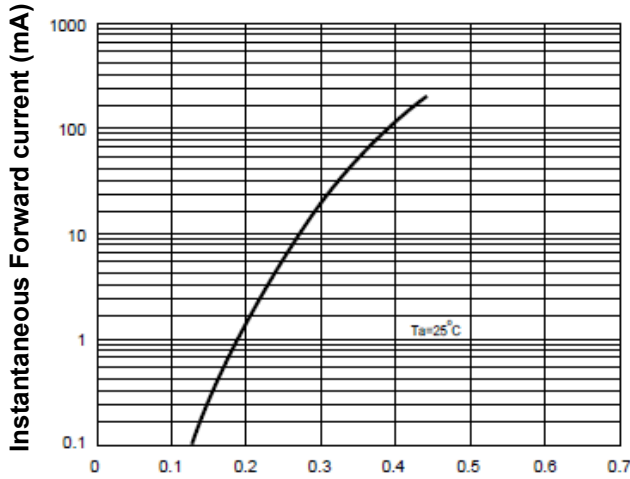
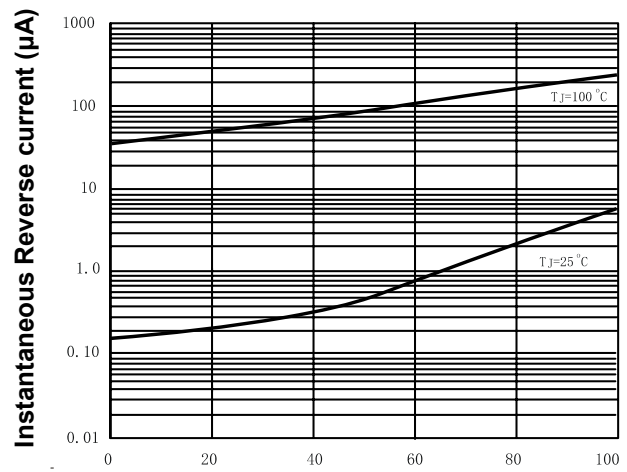

Fig.2- Max. Non-Repetitive Forward Surge Current



Instantaneous Forward Voltage (V)
Fig.3- Typical Forward Characteristics



Percent of Rated Peak Reverse Voltage(%)
Fig.4- Typical Reverse Characteristics

200mA Low Profile Chip Schottky Rectifier

TSCD022WT-TSCD024WTR

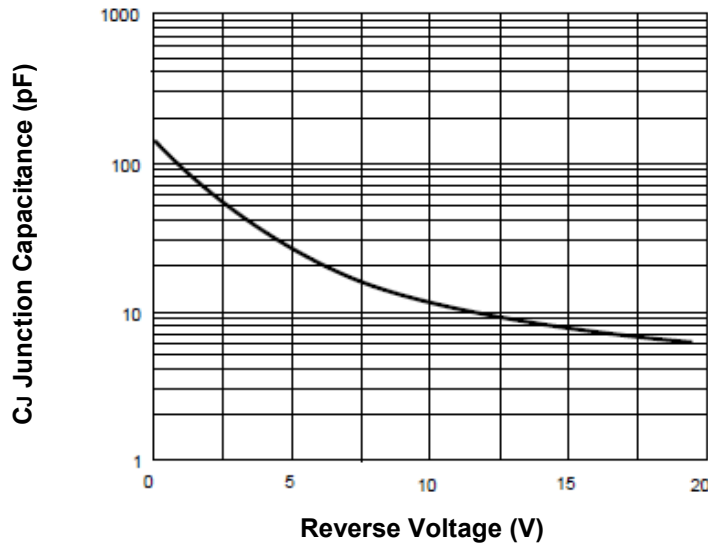
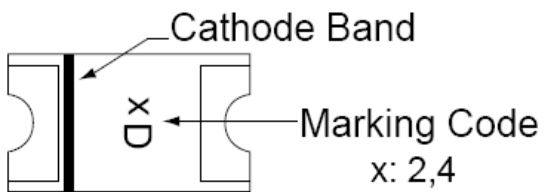

Fig.5-Typical junction capacitance

Marking Information:

TSCD022WT TSCD024WT



TSCD022WTR TSCD024WTR

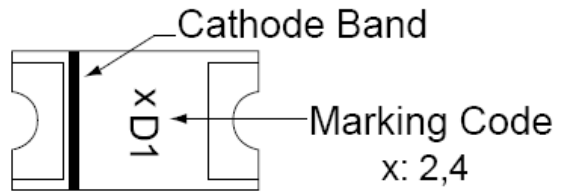

200mA Low Profile Chip Schottky Rectifier

TSCD022WT-TSCD024WTR

Dimensions in inch (mm)

C0603
(SOD-523)

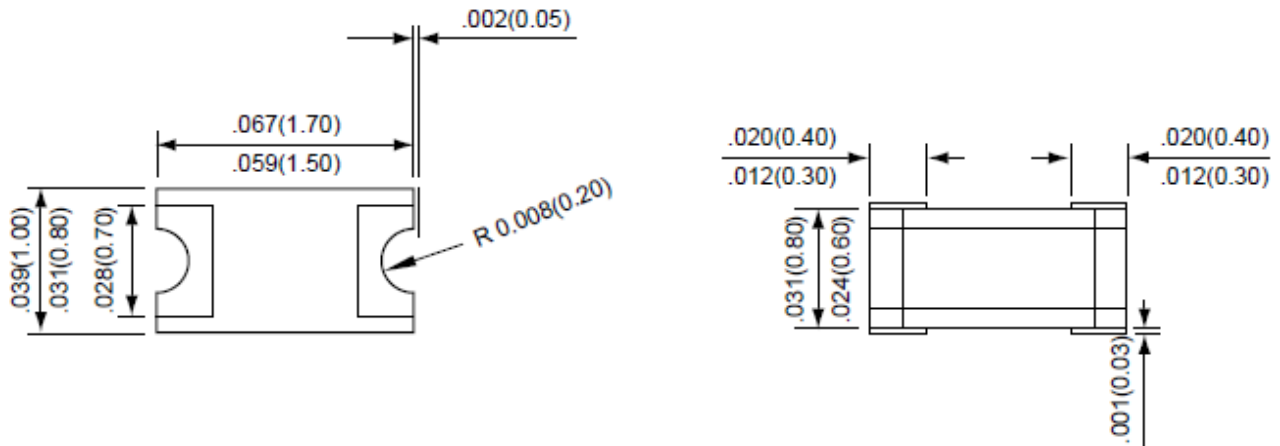

How to contact us:

US HEADQUARTERS

28040 WEST HARRISON PARKWAY, VALENCIA, CA 91355-4162

Tel: (800) TAITRON (800) 824-8766 (661) 257-6060

Fax: (800) TAITFAX (800) 824-8329 (661) 257-6415

Email: taitron@taitroncomponents.com

Http://www.taitroncomponents.com

TAITRON COMPONENTS MEXICO, S.A .DE C.V.

BOULEVARD CENTRAL 5000 INTERIOR 5 PARQUE INDUSTRIAL ATITALAQUIA, HIDALGO C.P.
42970 MEXICO

Tel: +52-55-5560-1519

Fax: +52-55-5560-2190

TAITRON COMPONENTS INCORPORATED REPRESENTAÇÕES DO BRASIL LTDA

RUA DOMINGOS DE MORAIS, 2777, 2.ANDAR, SALA 24 SAÚDE - SÃO PAULO-SP 04035-001 BRAZIL

Tel: +55-11-5574-7949

Fax: +55-11-5572-0052

TAITRON COMPONENTS INCORPORATED, SHANGHAI REPRESENTATIVE OFFICE

METROBANK PLAZA, 1160 WEST YAN' AN ROAD, SUITE 1503, SHANGHAI, 200052, CHINA

Tel: +86-21-5424-9942

Fax: +86-21-5424-9931