

TX2-802B

SMD TCXO
Clipped sine wave

QuartzCom
the communications company



Features

- Applications: mobile communications, GPS, instrumentation, microwave
- Frequency range up to 50 MHz
- Tight frequency stability vs. temperature
- Low phase noise

Parameter	Specification		
	TX2-802BL	TX2-802BM	TX2-802BS
Frequency range	9.6 ~ 50 MHz		
Standard frequencies	10.00, 13.00, 16.384, 19.20, 19.44, 20.00, 20.48 & 27.00 MHz		
Frequency stability:			
vs. temperature	≤ ±1.0 ~ ±2.5 ppm		
vs. supply & load change	≤ ±0.2 ppm	±5 %	
vs. aging	≤ ±1.0 ppm	1 st year	
Frequency tolerance ex. factory	≤ ±0.5 ppm @ +25 °C		
Supply voltage	+3.0 V ±5 %	+3.3 V ±5 %	+5.0 V ±5 %
Supply current	1.5 ~ 4 mA		
Output signal	> 0.8 Vp-p	clipped sine wave	
Output load	10 kΩ // 10 pF		
Frequency adjustment	> ± 3 ppm	by internal trimmer	
Phase noise @ 13.0 MHz carrier frequency	-140 dBc/Hz	@ 1 kHz	
Operating temperature range	-30 ~ +75 °C	commercial application	
	-40 ~ +85 °C	industrial application	
Storage temperature range	-55 ~ +125 °C		
Packaging units	tape & reel	500 or 1'000 pieces	
Customer specifications on request			

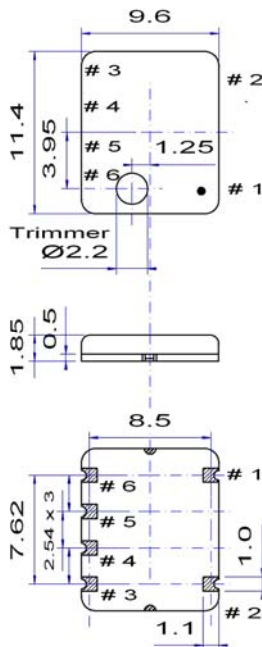

Pin function

- # 1 not connected
- # 2 GND
- # 3 Output
- # 4 GND
- # 5 not connected
- # 6 Vcc

Example for solder pattern

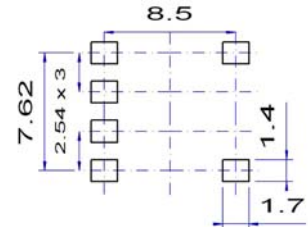

Do not design any conductive path between the pattern

Example for IR reflow soldering temperature

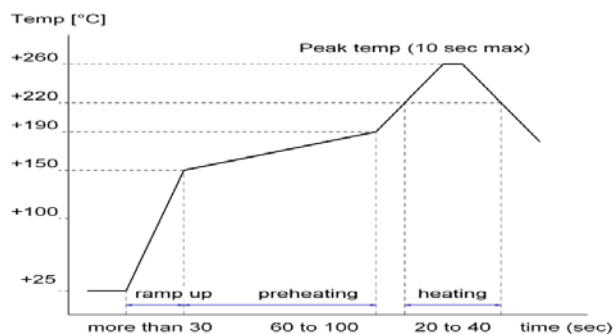

2002/95/EC RoHS compliant

QuartzCom AG
sales@quartzcom.com

QuartzCom Asia
sales-asia@quartzcom.com

QuartzCom USA
sales-usa@quartzcom.com

www.quartzcom.com

ISO 9001
BUREAU VERITAS
Certification



30 Apr. 10